



# WRHC 2016

DIVERSIFYING  
HONORS:

INNOVATION  
CONTRIBUTION  
GLOBAL CITIZENSHIP





# Western Regional Honors Council

## 43rd Annual Conference

### April 8-10, 2016

Hosted by the University of California, Riverside  
at the Riverside Convention Center  
Riverside, California

#### **Conference Organizers:**

##### ***University of California Riverside, University Honors***

Dr. Richard Cardullo, Howard H Hays Jr. Chair and Faculty Director

Aaron Bushong, Administrative Director

Latoya Ambrose, University Honors Counselor - Events & Leadership

Mayra Jones, University Honors Counselor - Student Engagement

Jane E. Kim, University Honors Counselor - Marketing & Media

Lourdes Maldonado, University Honors Counselor - Outreach, Alumni, & Affiliated Programs

Kristine Parada, University Honors Office Manager

##### ***UCR Honors WRHC Interns***

Jessica Gonzalez-Lopez

Yo Yo Hong

Melanie Queponds

Ricky St. Claire

**Conference logo, program design, and layout by UCR Honors student Paulina Laroya**





**HOUSE OF REPRESENTATIVES  
WASHINGTON, D.C. 20515**

April 8, 2016

Dear Friends,

I am delighted to send my greetings and best wishes to you on the occasion of the Western Regional Honors Council's 43rd annual conference. I am thrilled that the WRHC chose to hold this event - for the first time - in the heart of Riverside.

This year's theme is "Diversifying Honors: Innovation, Contribution, & Global Citizenship." It is a fitting title for a gathering that promises to increase engagement and foster scholarship in a city that is home to four institutions of higher education - California Baptist University, La Sierra University, Riverside Community College, and The University of California - Riverside. Tonight's conference facilitates collaboration between students, faculty, and staff from over 45 institutions from the western region.

I would especially like to acknowledge the host institution, the University of California - Riverside, for providing a quality education to all students for over 60 years. Within this institution, University Honors has provided outstanding opportunities to high achieving students for nearly three decades. Our nation depends on these talented scholars to develop into the next generation of leaders and spread prosperity in our communities.

I am thrilled that so many people were able to attend this year's conference, and thank you for all your hard work and dedication. Please accept my best wishes for a memorable meeting and continued success.

Sincerely,

MARK TAKANO  
Member of Congress





*City of Arts & Innovation*



April 8, 2016

Welcome to Riverside – The City of Arts & Innovation!

We are pleased and truly honored to host the Western Regional Honors Council (WRHC) annual conference. On behalf of the City of Riverside, we would like to thank and welcome all of the guests, visitors, and attendees to this prestigious event.

Riverside is a big city with small-town hospitality. With more than 300,000 residents, our city has activities for everyone. Riverside has 59 parks and community centers, each with a range of sports and recreational options.

Our Fox Performing Arts Center showcases top-name performers in its historic, yet intimate, setting. We are home to over 50,000 higher education students at four college campuses including the University of California-Riverside, Riverside Community College, La Sierra University, and California Baptist University. In addition, our dedication to sustainability resulted in Riverside being the first city in California to be named an "Emerald City" by the California Department of Conservation.

Downtown Riverside is a charming place with a great sense of history that you will never forget. The Mission Inn Hotel & Spa, a national historic landmark, offers exquisite dining. The adjoining Main Street Mall contains unique shopping opportunities, coffee houses, and numerous eateries.

I know your experience in Riverside will be memorable and enjoyable. To the participants of the WRHC annual conference, I welcome you to our beautiful city.

Sincerely,

William "Rusty" Bailey III  
Mayor

3900 Main Street, Riverside, CA 92522 | Phone: (951) 826-5551 | Fax: (951) 826-5470 | [RiversideCA.gov](http://RiversideCA.gov)





# WELCOME

## From the University Honors Faculty Director, UC Riverside

Dear WRHC conference attendees:

Welcome to the 43rd annual meeting of the Western Regional Honors Council hosted by University Honors at the University of California, Riverside. We are particularly pleased to offer this conference in historic downtown Riverside at the newly renovated Riverside Convention Center. This year's theme, *Diversifying Honors: Innovation, Contribution, and Global Citizenship*, reflects many of the ideals of honors programs and colleges around the nation. These ideals are especially relevant in urban areas such as Southern California where we confront numerous social and environmental pressures related to a growing and diverse population within one of the planet's most fragile and threatened ecosystems.

This conference offers a wide array of individual and group talks, posters, and special events in the arts, humanities, social sciences, natural sciences, and engineering. I am particularly pleased that we have a number of sessions devoted to professional development that will serve as a venue for discussions between students, staff, and faculty who are committed to high quality scholarship that is fostered by robust honors experiences. For the students, you represent our best chance for the future that requires interdisciplinary approaches to solving our most pressing problems.

My best wishes to you for a rewarding conference.

Sincerely,



Richard A. Cardullo, Ph.D.  
Howard H Hays Jr. Endowed Chair, University Honors  
2016 WRHC Program Coordinator



# TABLE OF CONTENTS

|       |  |       |                           |
|-------|--|-------|---------------------------|
| 2     | Welcome from Congressman Mark Takano                   | 44    | Moderator Instructions    |
| 3     | Welcome from Riverside Mayor William<br>“Rusty” Bailey | 45    | Attending Institutions    |
| 4     | Welcome from UCR Honors Faculty Director               | 46    | Acknowledgments           |
| 6     | Welcome Address Speaker Bio                            | 47    | WRHC 2016 Sponsors        |
| 7     | Keynote Address Speaker Bio                            | 48    | Upcoming WRHC Conferences |
| 8-9   | Conference Schedule at a Glance                        | 49-51 | WRHC Constitution         |
| 10-11 | Riverside Convention Center Map &<br>General Info      | 52    | Notes                     |
| 12    | Friday, April 8 Detailed Schedule                      |       |                           |
| 13-34 | Saturday, April 9 Detailed Schedule                    |       |                           |
| 35-42 | Sunday, April 10 Detailed Schedule                     |       |                           |





# JOSE MEDINA

## WELCOME ADDRESS SPEAKER

Jose Medina was first elected to the California State Assembly in 2012. He represents California's 61st Assembly District, which consists of Riverside, Moreno Valley, Perris and Mead Valley.

During his first term in the Assembly, Medina led the effort to ensure the University of California, Riverside Medical School received \$15 million of full and continuous funding through the state budget to train students for crucial jobs in the health-care industry. In turn, those jobs will strengthen the region's economy, as well as improve health care accessibility in the Inland Empire.

Additionally, Medina passed legislation which assisted small businesses, helped protect seniors, and improved goods movement throughout the state. Medina brings to the legislature a lifetime of experience in education from his many years as a teacher with the Riverside Unified School District, also serving as a member of the Riverside City Teachers Association, and a representative to the state council of the California Teachers Association (CTA).

Medina's eagerness to assist students beyond the classroom motivated him to pursue public office. He served as school board member on the Jurupa Unified School District Board of Education and completed three successful terms on the Riverside Community College District Board of Trustees.

During his tenure as a Trustee, he chaired the Teaching and Learning Committee and supported establishing independent colleges in Riverside, Moreno Valley and Norco. Medina recognizes the critical role higher education plays in supporting jobs and opening up the doors for opportunity. He graduated from UC Riverside with a bachelor's degree in Latin American Studies, and a master's degree in History.

Assembly member Medina has two adult children, Jennifer and Matthew and two grandchildren, Elsa and Liam. He currently resides in Riverside with his wife, Linda.







# KELECHI A. KALU

## KEYNOTE ADDRESS SPEAKER

### **“INTERNATIONALIZATION: Navigating the Complexities of a Global Environment”**



Dr. Kelechi A. Kalu is Vice Provost of International Affairs and Professor of Political Science at University of California, Riverside. Kalu previously served as Associate Provost for Global Strategies and International Affairs and Professor of African American and African Studies at The Ohio State University. His Ph.D. (1997) is in International Studies from the Joseph Korbel School of International Studies, University of Denver. Kalu earned an M.A. (1988) in Political Science from the University of Dayton, Ohio and a BA (1986) in Political Science from University of North Texas, Denton, Texas.

His research and teaching interests are in International Politics, African Political Economy and U.S. Africa Relations. Kalu was a Mellon Research Fellow in the Department of Government, Connecticut College, New London, Connecticut in 1994–95, Professor of Political Science at the University of Northern Colorado, Greeley (1990–2008) and Faculty affiliate at the Mershon Center for International Security Studies at The Ohio State University.

Dr. Kalu is widely published and has served as a consultant to the World Bank on Public Sector Governance and to the Asian Development Bank on Managing Sustainable Development in Resource-Rich Countries. He is a recipient of grants from The Ford Foundation, The Mershon Center and The Korea Foundation. He is co-editor and contributor of *West Africa and the U.S. War on Terror* (Routledge, 2013), *Territoriality, Citizenship and Peacebuilding: Perspectives on Challenges to Peace in Africa* (UK: Adonis and Abbey, 2013) and *United States–Africa Security Relations* (Routledge, 2014).





# CONFERENCE SCHEDULE

## FRIDAY0408

**2PM-6PM Registration & Information**  
Marriott Lobby

**4PM-5PM Scribendi Reading**  
Culver Center of the Arts, Downtown

**5PM-6:30PM Welcome Reception**  
Grier Pavillion at City Hall

**6:30PM Dinner/evening on your own**

## SATURDAY0409

**7AM-12PM Registration & Information**  
Convention Center - Concourse 201

**8AM-9AM Breakfast**  
Raincross Ballroom

**9:10AM-10AM Workshop Session 1**  
Diversity in Artistic, Musical, & Religious Expression - MR1  
Innovative Education - MR2  
Societal Concerns in Culture, Philosophy, & Ethics - MR3  
Disease Engineering, Prevention, & Treatment - MR4  
Politics, Gender, & Religion - MR5  
Hidden Stories in Art - MR6  
Adventures in Nanomedicine - MR7  
Study Abroad Experiences - MR8  
Ecology & Legacy: An Integrated Honors Minor That Connects "The Local" to "The Global" - MR9  
The History of Differentiation: Applying Definitions - MR10

## SATURDAY0409 (CONT.)

**10:10AM-11AM Workshop Session 2**  
Different Perspectives of an Integrated World - MR1  
College Student Development- MR2  
Ethics in Medicine, Culture, & Literature - MR3  
Human Biology - MR4  
Mental Health - MR5  
Branding and Naming Honors Colleges - MR6  
Home Ownership: How the American Dream Brought Down the World Economy - MR7  
Audeamus: A "Daring" Multidisciplinary Honors Journal - MR8  
Burning the Standard Candle from Both Ends - MR9  
The Value of Student Research & Conference Presentations in Honors Courses - MR10  
Beyond the Resume: Honors Student Ambassadors - Ballroom B

**11:10AM-12PM Workshop Session 3**  
Societal Issues Challenging Identity & Connection - MR1  
Linguistics, Language, & Literature - MR2  
Ethics in World & Technology Development - MR3  
Literary, Historical, & Political Analyses - MR4  
Psychology & Development - MR5  
Cellular Structure & Function - MR6  
How to Efficiently Network: For Students Desiring a More Comprehensive Honors Experience - MR7  
Building an Ideal Community: Motivations for the Creation and Structure of the Honors College at Southern Oregon University - MR8  
Honors Study Room - MR9  
Unbound: Open Media, Closed Format - MR10  
First-Year Mentoring: Models from Nevada - Ballroom B

***\*MR = Meeting Room***





# AT A GLANCE

## SATURDAY0409 (CONT.)

12:10PM - 2PM **Riverside City Combo I,  
Keynote Address, & Lunch**  
Raincross Ballroom

2:10PM-3PM **Workshop Session 4**  
Gender Roles in the Arts - MR1  
Creative Writing Process - MR2  
Ethics & Politics - MR3  
Economics & Politics - MR4  
Issues in Higher Education - MR5  
Cell & Molecular Basis of Disease - MR6  
Where Everybody Knows Your Name: Student  
Leaders Nurture a Tight-Knit Community - MR7  
Promoting Empathy on Campus: Refocusing  
Holidays from Parties to Service- MR8  
Theatrical Storytelling & Music - MR9  
Cannabis Reform in Western Culture: A Budding  
Trend - MR10

3:10PM-4PM **Workshop Session 5**  
What Sells - MR1  
Dreamers: Undocumented Students in Higher  
Education - MR2  
Cinema through a Different Lens - MR 3  
Organismal Biology - MR 4  
Engineering Models - MR5  
Educational Tools for Youth - MR6  
Cultivating Leadership Skills with "Take the Lead  
Projects" - MR7  
(Mis)Represent: The Problem of Disney - MR8

*\*MR = Meeting Room*

## SATURDAY0409 (CONT.)

3:10PM -4PM **Workshop Session 5**  
Diversifying & Demystifying Honors Colleges:  
Creating a Sense of Belonging for Diverse  
Students - MR9  
Entangled Oppression: Diversifying our Under-  
standing of Oppression Across Species - MR10  
Using a Community Peer Mentoring Model in a  
General Education Honors Program - Ballroom B

4:10PM-6PM **Monte Carlo Casino Social**  
Raincross Ballroom

6PM **Dinner/evening on your own**

## SUNDAY0410

6:15AM-8AM **Mt. Rubidoux Hike**  
Meet at Marriott Lobby

8AM-9AM **Breakfast & Aventura**  
Exhibit Hall C

9:10AM-10AM **WRHC Business Meeting**  
Ballroom

9:10AM-12PM **Information Fair**  
Exhibit Hall D

9:10AM-11AM **Student Poster Session**  
Exhibit Hall D

11:10AM-12PM **Poster Awards and Close of Conference**  
Exhibit Hall C

12:10PM-1PM **UCR & SOU Conference Planning Transition  
Meeting**  
Exhibit Hall C





# RIVERSIDE CONVENTION CENTER

## MAP & GENERAL INFO

### Registration & Info Table

Please check in with the WRHC Registration and Information Table to obtain your conference badge, program, and other conference materials. Registration will be available for two days.

#### **Day 1: Friday, April 8, 2016**

Location: Marriott lobby

(hotel is directly across the Riverside Convention Center)

Time: 2:00pm — 6:00pm

#### **Day 2: Saturday, April 9, 2016**

Location: Convention Center (Concourse 201)

Time: 7:00am — 12:00pm

### Conference Badges & Meals

Name Badge should be worn at all times. Name Badges are required for entry at all WRHC events (Scribendi Reading, Welcome Reception, Monte Carlo Night, Meals, etc.).

Badges are provided with the conference registration materials you receive at check-in at the WRHC Registration and Information Table. Badges may not be transferred. If you lose your badge, please contact a WRHC staff or student intern.

### Conference Sessions

All conference sessions and covered meals on Saturday April 9 and Sunday April 10 will be held in the Riverside Convention Center. Please refer to the map on the opposing page for room locations.

Activities on Friday, April 8 will be held in downtown Riverside (please refer to the detailed schedule for this day for activity locations).

### Media/AV

Each room will be equipped with a projector and a screen. Any other equipment will be the responsibility of the presenter(s).

### Parking

The closest parking available to the Riverside Convention Center is parking lot (Lot 33) located on Third Street. Parking is \$8.00 per vehicle. Attendees can pay cash to the attendant upon entry to the parking lot. If you are paying with a credit card you will have to pay at our meter located in the lower level of the parking lot near the executive office. The meter will dispense a receipt that you will need to place on your dashboard.

If you are staying in the area at any of the recommended hotels, the Riverside Convention Center is within walking distance of these hotels (Marriott, Hyatt Place in Downtown Riverside, Mission Inn).

For all parking options, please refer to the colored parking map provided with your conference registration materials. Generally, on Fridays, street parking is free after 5:00pm. Generally, on the weekends, there is free street and covered parking in various locations across downtown Riverside.

### UCR & Riverside

We invite you, as you have time, to visit UCR and explore downtown Riverside. Although no formal tours are available, maps and additional information have been provided in your registration packet to discover our campus and our city at your own leisure.

### WRHC

The Western Regional Honors Council (WRHC) is a professional organization of faculty, administrators, and students dedicated to the promotion and advancement of undergraduate honors education. The WRHC represents honors programs in universities across the Western region.

The objective of this council shall be the promotion and advancement of honors and similar programs in Western colleges and universities.



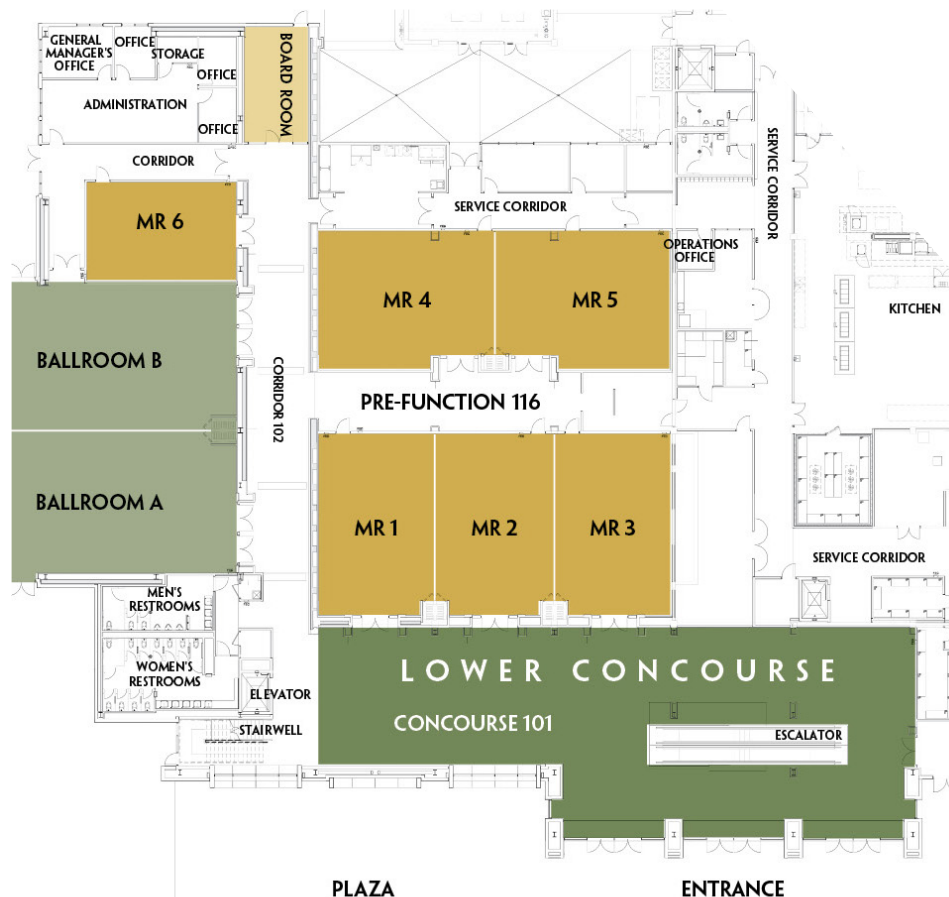

**1st Floor:**  
**Meeting Rooms 1-6,**  
**Ballroom A, B**  
**Concourse 101**

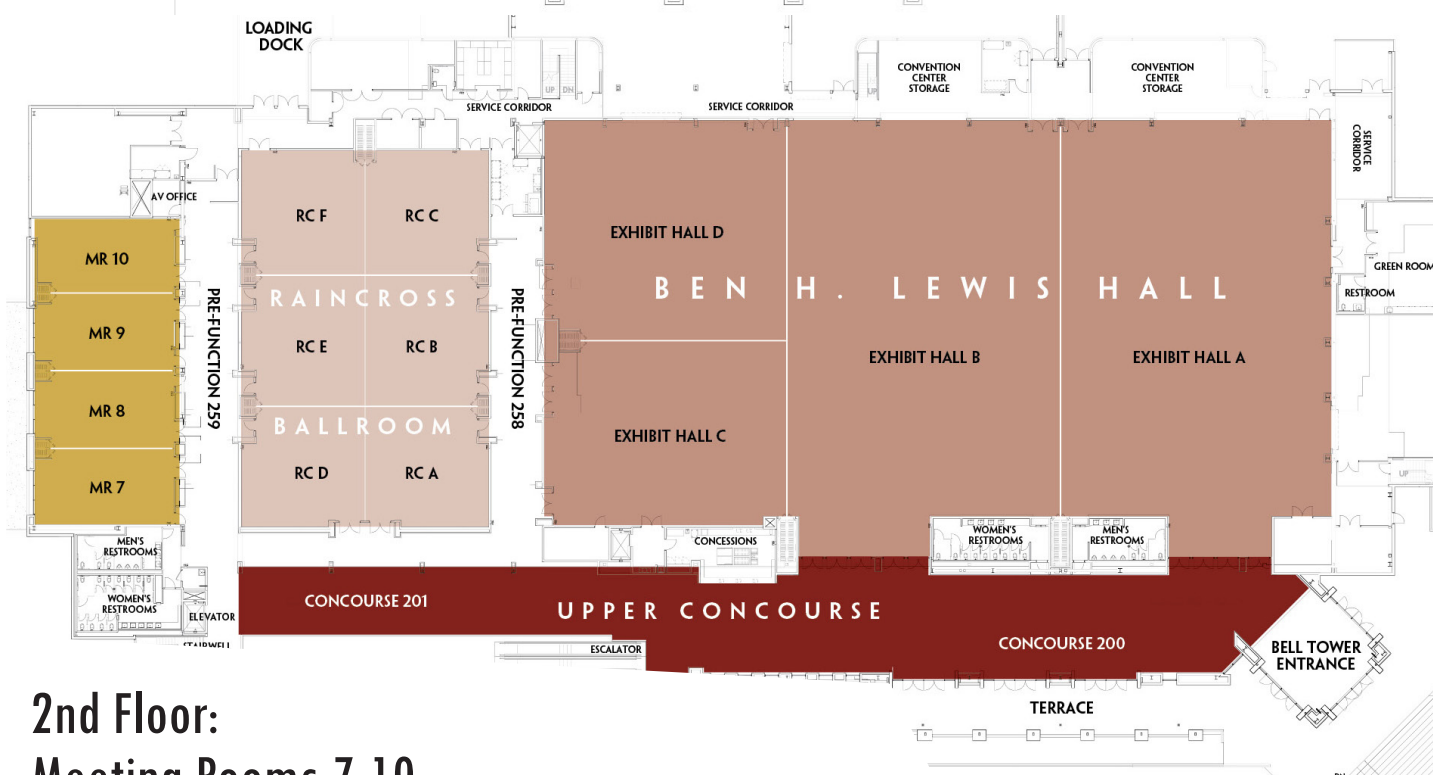

**2nd Floor:**  
**Meeting Rooms 7-10,**  
**Raincross Ballroom, Exhibit Halls C & D**  
**Concourse 201**



# Friday April 8

## DETAILED SCHEDULE

### REGISTRATION & INFORMATION 2:00PM-6:00PM MARRIOTT LOBBY

*Name Badge should be worn at all times. Name Badges are required for entry at all WRHC events (Scribendi Reading, Welcome Reception, Monte Carlo Night, Meals, etc.)*

### SCRIBENDI READING 4:00PM-5:00PM CULVER CENTER OF THE ARTS DOWNTOWN RIVERSIDE

#### **Scribendi Winners**

Selina Foster - Poetry - "Imitations" - Westminster College

Kimberly Schneider - Open Media - "Wino" - University of New Mexico

Tatiana Olivera - Creative Nonfiction - "Just Believe" - CSU Stanislaus

Diane Chavez - Short Fiction - "The Caves" - University of Nevada, Las Vegas

Aloe Corry - Visual Art - "Appraisal" - Brigham Young University

Joshua Lane - Photography - "Light (On a Canvas of Stars)" - University of New Mexico

### 5:00PM-5:15PM, WALK TO GRIER PAVILION RIVERSIDE CITY HALL, 7TH FLOOR

### WELCOME RECEPTION, 5:00PM-6:30PM

*Light refreshments will be provided.*

### DINNER/EVENING ON YOUR OWN, 6:30PM





# Saturday April 9

## DETAILED SCHEDULE

### REGISTRATION & INFORMATION

7:00AM-12:00PM

### CONVENTION CENTER CONCOURSE 201

*Name Badge should be worn at all times. Name Badges are required for entry at all WRHC events (Scribendi Reading, Welcome Reception, Monte Carlo Night, Meals, etc.)*

### BREAKFAST & WELCOME ADDRESS

8:00AM-9:00AM, RAINCROSS BALLROOM

### SESSION 1: 9:10AM-10:00AM

#### DIVERSITY IN ARTISTIC, MUSICAL, & RELIGIOUS EXPRESSION, MEETING ROOM 1 (MR1)

**Megan McCarthy, MiraCosta College**

***For the Love of God: An Examination of the Role of Religion in a Modern Age of Enlightened Critical Thinking***

Since the Enlightenment, philosophers have been predicting the end of religion. This presentation argues that religion, much like the concept of love, serves a deeply functional role in society. This functional purpose, I argue, is what allows religion to survive in a modern world that demands reasonable, rational explanation.

**Sierra LaPoint, University of California, Riverside**

***The Dynamic Ontologies of the Kalacakra Sand Mandala***

The Kalacakra initiation rite revolves around the creation and destruction of a complex sand mandala. This mandala is being integrated into the American cultural landscape as a result of the Tibetan diaspora. Using qualitative research and theories of material religion, I discuss the mandala's development of new ontological modes.

**Elizabeth Phillips, University of Nevada, Reno**

***Ensemble Organum and Ethnomusicology: a Critical Diversification of the Western Chant Tradition***

One critical issue with Western ethnomusicology is the euro-centricity of our early canon. In an effort to expose the cultural diversity of Western musical traditions I have compiled and related historical evidence for musical exchange between Medieval Greek, Jewish, Byzantine, and Roman Catholic cultures, and also examined contemporary hybridized performances.







# SESSION 1 (cont.): 9:10AM-10:00AM

## **INNOVATIVE EDUCATION, MEETING ROOM 2 (MR2)**

**Bronwyn Clarke and Kate Drohman, University of Washington, Tacoma**

### ***How to Do Global Research: You Don't Have To Go To Haiti***

This presentation will discuss our journey into global research through our undergraduate capstone project on the 'glocal' implications of national technology initiatives in disadvantaged schools. Through this experience, we've learned what it means to do global research and how to look at issues through the lens of global citizenship.

**Jason Hawes - California State University, Fullerton**

### ***Motivation & Procrastination in College Students: Dissimilarities Between Enduring & Performance-Based Learning***

This research seeks out the most effective ways of motivating students in the classroom to foster an environment that promotes enduring learning rather than temporary, performance-based learning. The purpose of this research is to identify the difference between interim and ingrained learning, and the implications of such on GPA.

**Alyssa Brown - Southern Utah University**

### ***Education Beyond the Syllabus: Encouraging Honor's Students to Become Deep Learners***

Current syllabi for many college courses are designed to encourage students to aim for strategic learning. Three sample syllabi were constructed within the subjects of anthropology, biology and chemistry to demonstrate deep learning and help students extrapolate to their own interests and move their education beyond the classroom.

## **SOCIETAL CONCERNS IN CULTURE, PHILOSOPHY, & ETHICS, MEETING ROOM 3 (MR3)**

**Kalen Daniels - Sierra Nevada College**

### ***Utilitarianism***

I will be discussing the origin and meaning behind Utilitarianism and its effect on society from the Enlightenment to present day. I describe what Utilitarianism is, who created it, different aspects of the philosophy and the impact it has had, does have, and will have.

**Ulises Lopez Castaneda - GateWay Community College**

### ***A Culture of Privilege***

An analysis of history and society to identify origins of privilege, this presentation focuses on the adverse effects of privilege, and the culture that this creates, with a specific focus on Colorism and Western Imperialism. This presentation highlights examples, problems, and solutions in order to understand "A Culture of Privilege."

**Jamie Starkey - Sierra Nevada College**

### ***Ethics of Human Genome Editing***

Human genome editing raises numerous ethical issues. The potential for altering the human germline, making gene alterations inheritable by our children, is a major concern. A mistake in germline alteration could end up harming future individuals by placing that same mistake in every cell.







# SESSION 1 (cont.): 9:10AM-10:00AM

## **DISEASE ENGINEERING, PREVENTION, & TREATMENT, MEETING ROOM 4 (MR4)**

**Phyllis Gitobu - MiraCosta College**

### ***Glow-in-the-dark Monkeys: A Look Into the Potential Use of Genetic Engineering in Medicine***

This research explores the field of genetic engineering. Current case studies are used to illustrate how this technology can potentially be utilized to cure individuals of deadly genetic diseases by transplanting new DNA into their dysfunctional cells, therefore; genetic engineering can act as a viable tool to eradicate genetic disorders.

**Matthew Hovey - Flathead Valley Community College**

### ***One Step Closer: Defeating Malaria and Dengue Simultaneously***

This project walks through the effects malaria and dengue have on the world and what scientists can do to reduce the spread of these diseases. By using a bacteria called Wolbachia, scientists can reduce the amount of malaria and dengue infected mosquitos, thus reducing the number of human cases.

**Keesha Matz - Washington State University**

### ***Nipah Virus: A Global Virus with Deadly Impacts***

Nipah Virus (NiV) is a deadly pathogen with a mortality rate of 40-90% in humans. It is classified as dangerous biological agent category like Ebola. NiV poses a great threat and has bio-terrorism potential. It is imperative that we understand the viruses' infection process in order to develop antiviral treatments.

## **POLITICS, GENDER, & RELIGION, MEETING ROOM 5 (MR5)**

**Kristina Moisa - University of California, Riverside**

### ***The Recent Effects of the Anti-Rape/Anti-Sexual Assault Movement on U.S. College Campuses***

Sexual assault crimes have always been present on college campuses, but the upsurge of the anti-rape/anti-sexual assault movement has recently gained momentum. I have observed the gaps between college administrations fixing the reporting process and ending the stigma of sexual violence—which is detrimental for the empowerment of victims and survivors.

**Benjamin Newcomb - Mesa Community College**

### ***The Language of Gender***

Language and gender are two integral components of what makes us human, therefore it is important to understand how they are related. Language also plays a key role in defining gender identity, dictating gender expression, and reflecting gender equality in a society.

**Edgar Zamora - William O. Douglas Honors College at Central Washington University**

### ***Voting Behavior of Catholic Hispanics in Yakima County, WA***

Catholicism, currently the most popular religion among Hispanics in the United States, is decreasing in popularity. Catholic influence in politics still persists in Yakima County, WA. Interviews and surveys will be conducted with local churches to determine whether Catholic Hispanics are able to separate religious and political views when voting.



# SESSION 1 (cont.): 9:10AM-10:00AM

## HIDDEN STORIES IN ART, MEETING ROOM 6 (MR6)

**Logan Ashworth - Southern Utah University**

### ***The Taste of Art***

The Taste of Art explores how the barrier between canvas and viewer may be broken. The presenter has composed a cookbook derived from hundreds of years of art, resulting in an eccentric understanding of art. This presentation strives to engage its viewers to look at art a completely novel way.

**Krista Zimmerman - William O. Douglas Honors College at Central Washington University**

### ***The Nature of Our Nature: An Exploration of Human Nature Through the Language of Surrealist Art***

This presentation describes the creation of a painting series in which I explore the details and idiosyncrasies of human nature. I will explain the process of creating large-scale oil paintings and describe why surrealistic art is so suited to describing the deeply psychological, philosophical, and biological topic of human nature.

## ADVENTURES IN NANOMEDICINE, MEETING ROOM 7 (MR7)

**Chase Hanson and Ben Laster - Flathead Valley Community College**

As the world of medicine advances, one technology is becoming impossible to ignore. This is nanotechnology. The basic idea behind nano-medicine is using microscopic machines or robots to replace the physician. The implications of these advancements in medicine can lead one to ponder the ethical issues.

## STUDY ABROAD EXPERIENCES, MEETING ROOM 8 (MR8)

**Allison Blair - University of Nevada, Reno**

### ***In Defense of Study Abroad: Disproving the Stereotypes***

With support from my Honors Program's Study Abroad Scholarship, I completed a five-week bioarchaeology field school on Spike Island, Ireland. Upon returning, I read a fellow student's editorial entitled "Studying abroad is a waste of time." My overwhelmingly positive experience inspired this presentation, which seeks to debunk study abroad stereotypes.

**Steven Lee - University of Nevada, Reno**

### ***One World: My Experience at Mundubat***

In Bilbao, Spain, I worked with Mundubat, an organization that promotes economic and social growth in developing countries. Studying abroad with the support of my Honors Program prepared me to enter the global economy and let me see how my education relates to my future work.

**NingXin Wang- University of Nevada, Reno**

### ***Expanding the Study Abroad Experience***

My Honors Program prepared me for the challenges I faced while studying abroad at St Andrews, the most prestigious university in Scotland. The Program helped me to feel secure in my abilities and to have the confidence to accomplish the academic, professional, and personal goals I set for myself.





## SESSION 1 (cont.): 9:10AM-10:00AM

### **ECOLOGY & LEGACY: AN INTEGRATED HONORS MINOR THAT CONNECTS “THE LOCAL” TO “THE GLOBAL,” MEETING ROOM 9 (MR9)**

**Andy Hoffman, Sarai Patterson, Sylvia Torti, and Weston Wood - University of Utah**

Two faculty and two student participants will provide an overview of an Integrated Honors Minor called Ecology and Legacy, which took place in Utah, Montana and Argentina in summer 2015. This is the first of a series of integrated local-global minors being developed at the University of Utah Honors College.

### **THE HISTORY OF DIFFERENTIATION: APPLYING DEFINITIONS - MEETING ROOM 10 (MR10)**

**Brigid McCarthy, Farshud Sorourifar, and Alejandro Stephens - MiraCosta College**

The evolution of derivation allows students to better understand differentiation, and how different definitions have unique value in certain applications of differentiation. Applying Caratheodory's definition of the derivative, most commonly used in complex differentiation, may allow for easier evaluation of the differentiability of functions from  $\mathbb{R}^n$  to  $\mathbb{R}^m$ .

## SESSION 2: 10:10AM-11:00AM

### **DIVERSE PERSPECTIVES OF AN INTEGRATED WORLD, MEETING ROOM 1 (MR1)**

**Kim Anderson - Washington State University**

***Faculty-led Trips to Scandinavia and Spain***

Global Citizenship is of obvious importance as a preparation for the complex integrated world we live in. Since 2000, I have conducted 13 summer faculty-led trips alternatively to the Nordic countries and to the Iberian Peninsula. In this presentation I will discuss the many different aspects of a faculty-led trip.

**Scott Halliday - William O. Douglas Honors College at Central Washington University**

***Cost/Benefit Analysis: Increased U.S.-Mexico Border Security and Attempts to Reduce Undocumented Immigration***

Current immigration policy is centered on border security and on decreasing the number undocumented immigrants. This study will present findings on the cost and benefits of reducing the number of undocumented immigrants in the United States and increasing U.S.-Mexico border security, and whether this is the best course of action.

**Daniel Waqar - University of Nevada, Las Vegas**

***Assessing Understandings of the Israeli-Palestinian Conflict: A Peace and Conflict History of Hebron, the Occupied West Bank***

Despite the vast research on the Israeli-Palestinian conflict, little is known about the contemporary history of peace and conflict efforts in Hebron, the largest city by population in the Israeli-occupied West Bank. This study will analyze the intersecting themes of violence and power in Hebron within the Israeli-Palestinian conflict's context.





# SESSION 2 (cont.): 10:10AM-11:00AM

## COLLEGE STUDENT DEVELOPMENT, MEETING ROOM 2 (MR2)

**Alaina Daum - Scottsdale Community College**

### ***Study Abroad: A Vital Tool to Global Citizenship and Diverse Education***

One crucial component to foster a global citizen mindset is to experience many cultures. Colleges should support study abroad programs so that students not only experience other cultures, but are immersed in them to fully experience worldwide innovation, while building and strengthening international bonds and contributing to foreign communities.

**Justice Malone - Mesa Community College**

### ***Emerging Adulthood***

This presentation will bring to light what it means to be an emerging adult. It will explain the mindset of an emerging adult transitioning from high school to college. It will also explain what an emerging adult must prepare for when entering a constantly changing technological workforce.

**Marli Mayon - Scottsdale Community College**

### ***The Community College: A Too Often Overlooked Option***

Community college education makes vital contributions to its community through innovative programming. Lesser-known but valuable programs will be detailed to increase the prestige of the community college as a viable option for diverse populations, while attempting to dispel the “lesser than” stigma often unfairly associated with a community college education.

## ETHICS IN MEDICINE, CULTURE, & LITERATURE, MEETING ROOM 3 (MR3)

**Alexandra Escobar - MiraCosta College**

### ***Cultural Tourism: Traditions Turned Commodities***

Original practices of cultural tourism proved detrimental to a cultures traditions. Modern practices have ameliorated problems by encouraging participation of locals and reducing exploitation by government agencies. Cultural tourism is a 20-billion-dollar-a-year industry, and it grows every year. It is imperative to ensure that cultures are not harmed in the process.

**Alice Hiemstra - Washington State University**

### ***Beauty in Exemplary Women in Early China***

In Liu Xiang's Biographies of Exemplary Women of Early China 'beauty' leads men to compromise their morals and to the destruction of dynasties. The biographies were possibly a warning of the dangers of beauty, and an exhortation to women to control 'beauty' for the good of family and the state.

**Havilland O'Briant - Flathead Valley Community College**

### ***Uterine Transplantation***

I will be presenting on the ethicality of uterine transplantation and will encourage ethical conversation by explaining the procedure and ethical criticism surrounding it. I will examine ethical issues through the lenses of feminism, deontology, and scientific wellbeing. Finally, I will argue for the ethicality of the procedure.





## SESSION 2 (cont.): 10:10AM-11:00AM

### **HUMAN BIOLOGY, MEETING ROOM 4 (MR4)**

**Paria Ali Pour - University of California, Irvine**

#### ***Role of Ovol2A Protein in Pancreatic Cancer Pathogenesis***

This project studies the role of Ovol2A protein, a member of zinc transcription factor family, in pancreatic cancer pathogenesis, using an Ovol2A constitutive expression system, a tetracycline inducible overexpression system, and a knockdown system. Our result suggests that Ovol2A may have a protecting role against pancreatic cancer metastasis.

### **Westley Hughes - Flathead Valley Community College**

#### ***Human Head Transplantation***

It has been the subject of science fiction for decades, but human head transplantation may now be within reach. Topics to be covered include the recent history and process of head transplanting; then perspectives of three ethical theories will be analyzed to determine the morality of this procedure.

### **Samuel Nelson - Mesa Community College**

#### ***ATP: The Molecule That Moves You***

ATP (Adenosine Triphosphate) is the currency of the human body that drives cellular work and allows life to move forward. This project explains how the structure of ATP is vital in functions associated with energy. ATP is utilized by cells in muscular contractions, which convert ATP to ADP + P.

### **MENTAL HEALTH, MEETING ROOM 5 (MR5)**

**Tomiko Cook - Flathead Valley Community College**

#### ***Psychedelics in Therapy***

Focusing on the recently completed MDMA assisted psychotherapy done with PTSD patients, as well as the human clinical trials done with psilocybin at John Hopkins University, we will explore what the term psychedelic means, as well as the stigma, obstacles and implications surrounding research today and in the future.

### **Yelda Falahahwazi - El Camino College**

#### ***Self-Induced Reclusion: The Impact of Social Anxiety Disorder Among College Students***

Social anxiety disorder, revolving around the debilitating fear of judgement or humiliation, significantly impedes college students' functioning wherein it permeates all aspects of their lives. The behaviors adopted to cope with this disorder can result in emotional instability and feelings of loneliness that are detrimental to the student's learning process.

### **Sarah Lainez - GateWay Community College**

#### ***Controversies of Dissociative Identity Disorder***

This presentation will provide an overview of Dissociative Identity Disorder, focused on the controversy surrounding recent changes to the diagnostic criteria for this disorder, as well as in diagnosing DID. The presentation will delve into what DID is, causes, symptoms, diagnosis, and treatment of DID, using a case study.

# SESSION 2 (cont.): 10:10AM-11:00AM

## **BRANDING AND NAMING HONORS COLLEGES, MEETING ROOM 6 (MR6)**

**Dr. Lee Gordon - Orange Coast College**

An Honors College provides a university or college with unique branding and naming rights opportunities. This presentation will focus on the value of a distinct name to the branding of Honors Programs and Honors Colleges. It will discuss the appeal of an Honors College to donors interested in naming opportunities.

## **HOME OWNERSHIP: HOW THE AMERICAN DREAM BROUGHT DOWN THE WORLD ECONOMY, MEETING ROOM 7 (MR7)**

**Yongdeuk Kim and Christopher Lamb - Orange Coast College**

2008 saw the largest credit crisis in U.S. history since the Great Depression. While the effects of the Great Recession are widely known, the causes are very much lost in media speculation. Bringing to light the intricacies of financial systems in 2008 will help prevent another crisis in the future.

## **AUDEAMUS: A “DARING” MULTIDISCIPLINARY HONORS JOURNAL, MEETING ROOM 8 (MR8)**

**Adrienne Blackwood, Megan Krum, and Raymond Tran - University of California, Riverside**

*Our journal is cool.*

*Come see our presentation.*

*Five more syllables.*

We're bad at haikus, but have kept the Audeamus (Latin for "We dare") Honors journal running for a decade! Come celebrate our 10th anniversary and learn about publishing a student-run journal. We've got free cupcakes. And moustaches.

## **BURNING THE STANDARD CANDLE FROM BOTH ENDS, MEETING ROOM 9 (MR9)**

**Jessica Artinger and Hali Dickinson - Orange Coast College**

We are constructing a Hubble Diagram using the properties from a large sample of galaxies including those where Type Ia Supernovae have also occurred; then determining if this is a useful tool for us to use when measuring extragalactic distances.





## SESSION 2 (cont.): 10:10AM-11:00AM

### THE VALUE OF STUDENT RESEARCH & CONFERENCE PRESENTATIONS IN HONORS COURSES, MEETING ROOM 10 (MR10)

**Dr. Diana J. Kyle and student presenters: Irene Brutlag, Mireya Garcia, Francisca J. Niculae, Ashley Obregon, Stephanie Palmer, and Corina Salmon - Fullerton College**

Honors Research Methods students will describe the personal and professional benefits they derived from designing and conducting complete experiments and presenting their research at professional conferences. Gains in personal development in areas of self-efficacy, self-confidence, experience working on collaborative projects, and sense of personal accomplishment are presented.

### BEYOND THE RESUME: HONORS STUDENT AMBASSADORS, BALLROOM B

**Dr. Daniel Villanueva and student presenters: Shahil Pema and Rachel Wang - University of Nevada, Reno**

Of the 500 Honors students at the University of Nevada, Reno, only 15 are chosen to be Student Ambassadors via a competitive process. Many initially apply "just" for a resume item, but this presentation introduces three of the many dimensions going "Beyond the Resume": Recruitment, Retreat Planning, and Motivation.

## SESSION 3: 11:10AM-12:00PM

### SOCIETAL ISSUES CHALLENGING IDENTITY & CONNECTION, MEETING ROOM 1 (MR1)

**Jacqueline Cope - University of Nevada, Reno**

***Culture and the Glass Ceiling: How do Cultural Values and Norms Affect Women's Corporate Leadership?***

Studies show time and again that diverse governance can lead to better bottom lines, more customer loyalty, and innovation. How is it, then, that companies continue to operate using sexist practices? The following is an analysis of the cultural norms and values that lead to sexism at the corporate level.

**Courtney Potts - Sierra Nevada College**

***Troubled Youth***

Troubled Youth explores the recovery process of teen victims of abuse through literary entertainment. The paper embraces victims of abuse with the hope of starting a conversation with a wide variety of communities about the effects of bullying, suicide, violence and other difficulties that teens face every day.

**Seth Yund - Chapman University**

***Gender in Our Genes: Biological Misrepresentation in the Gender Binary Model***

Gender Identity is constructed individually, but societally gender is herded into a few socially acceptable categories. These categories are supported by a commonly held but incomplete understanding of how sex is biologically determined. Using examples from molecular and evolutionary biology, this presentation seeks to examine our socialized views of gender.





# SESSION 3 (cont.): 11:10AM-12:00PM

## LINGUISTICS, LANGUAGE, & LITERATURE, MEETING ROOM 2 (MR2)

**Lily (Shay) Daylami - University of Nevada, Reno**

### ***Let's Not Drag This Out: A Look at English Consonant Durations***

Segment length in English is non-contrastive, meaning that changing the length of a sound within a word will not change the word's denotation. Segment length does vary in English, but this variation is typically predictable. This presentation will discuss the possibility of an effect of word frequency on consonant length.

**Alexandra Rivas Ixtlahuac - California State Polytechnic University, Pomona**

### ***Tip of the Tongue Phenomenon in Bilinguals: Is There an Effect of Bilingual Language Control?***

The Tip of the Tongue Phenomenon -TOT-is considered to be a type of speech error in which speakers feel they do know the word but fail to retrieve it. Bilinguals show a higher number of TOTs than monolinguals. This research will provide a deeper understanding of TOTs in bilinguals.

**Rachel Steffen - Flathead Valley Community College**

### ***Dying Literature: Tuberculosis***

While understanding tuberculosis through the lenses of our past, writers provide us with an amplified vision of how our understanding and thoughts on the disease have changed over various periods. This is done through examining works from the biblical era all the way to 20th-century Kafka.

## ETHICS IN WORLD & TECHNOLOGY DEVELOPMENT, MEETING ROOM 3 (MR3)

**Sofya Bochkareva - Chapman University**

### ***Pizza Delivery and Other Uses of Drone Technology***

Remotely piloted aircraft known as drones have spiked in development in the recent years. From military machines to stocking-stuffer toys, drones are becoming a prominent entity in our lives. As such, we must weigh their pros and cons as we consider the implications of this technology on our daily lives.

**Grant Orzechowski - El Camino College**

### ***Privacy Law and the Internet: Staying Human in the Age of Information***

Just how private is your private information? Can something you post online ever truly be deleted? What is Mark Zuckerberg doing with your browser history? Find out here, in this presentation on the laws protecting your personal privacy and how they intersect with social media and other online services.

**Mandy Roland - Southern Utah University**

### ***Parallel Threats between the Deserts of Utah and the Subtropical Everglades***

This presentation will address threats shared between the subtropical Everglades and the arid Utah including invasive species, human land usage, and water conservation. The impact to both ecosystems will be compared and potential solutions will be discussed. This contrasting perspective will increase awareness of global threats along with the action to oppose them.







# SESSION 3 (cont.): 11:10AM-12:00PM

## LITERARY, HISTORICAL, & POLITICAL ANALYSES, MEETING ROOM 4 (MR4)

**Caleb Deane - Southern Utah University**

### ***Outcasts of the Universe: An Analysis of the Work of Nathaniel Hawthorne***

In the concluding paragraph of his short story "Wakefield," Nathaniel Hawthorne writes that the protagonist, Wakefield, has become "the Out-cast of the Universe." In my presentation I will explain what this phrase entails by drawing comparison from the protagonists of Hawthorne's short stories "The Birth-Mark" and "Young Goodman Brown."

**Melissa Hicinbothem - Fort Lewis College**

### ***The Man in the Black Leather Coat***

A panoptic analysis of Tom Rob Smith's Child 44 Trilogy and David Benioff's City of Thieves proved the existence of surveillance themes. This work examines the relevance of panoptic analysis to historical fiction and the Soviet Union, as well as generates an understanding of how history is understood.

**Tanner Lyon - Sierra Nevada College**

### ***The Soft Apocalypse: Social Injustice***

An informative analysis and critique of the current socioeconomic system. This speech references popular works by Marx, Deleuze, Marcuse, and Žižek. The arguments made by these philosophers are interpreted and adapted to advanced capitalism.

## PSYCHOLOGY & DEVELOPMENT, MEETING ROOM 5 (MR5)

**Mercedes Becker - University of Montana**

### ***Slam Poetry: An Online Intervention for Depression***

The presentation will be an oral presentation involving PowerPoint and will describe the development of the thesis, methods, results of the feasibility study, and next steps. If the website is finished, the design and URL will also be presented.

**Jennifer Montreuil-McGowan - Central Arizona College**

### ***Skydiving Personalities According to Discipline***

Researched based paintings and photographs about skydiving. Using the Kersey Temperament Sorter II and interviews of 69 skydivers, the researcher examines the dominant personalities within the sports of skydiving and Base Jumping. An interesting visual study of risk taking personalities.

**Zizhong (David) Xiao - University of California, Riverside**

### ***The Where of Happiness: Cross-Cultural Comparison of Happiness and Situational Experience***

The current project relates national-level situational experience and happiness across 21 countries. Analysis revealed that people in happier countries tend to experience situations characterized by properties such as power, annoyances, and criticism. Conversely, people in less happy countries tend to experience situations characterized by emotional arousal, and important, minor details.



# SESSION 3 (cont.): 11:10AM-12:00PM

## CELLULAR STRUCTURE & FUNCTION, MEETING ROOM 6 (MR6)

**Tasnim Ahmed - University of California, Irvine**

### ***Application of Electrospun Nanofibers for Cardiomyocyte Cell Culture***

This presentation describes a method of electrospinning nanofibers as a scaffold for cells. Cardiac muscle cells are cultured onto the fibers to investigate how alignment of these cells affects their tissue properties. These properties are used to infer the properties of the heart as an organ.

**Mariyam Habeeb - University of California, Irvine**

### ***Assessing Perineuronal Net Development in Endogenous and Transplanted Parvalbumin Interneurons***

Specialized extracellular matrix structures surrounding neurons called perineuronal nets are suspected to play a role in the onset and closure of critical period plasticity. This project looks at the development of these nets in transplanted embryonic stem cells in mice to gain an insight into their role in plasticity.

**Michelle Nemetchek - University of Montana**

### ***The Effect of Bacopa monnieri on the Release of the Proinflammatory Cytokines TNF- $\alpha$ and IL-6 from LPS Activated Microglial Cells***

This project seeks to isolate novel compounds from the Ayurvedic (Indian) medicinal plant Bacopa monnieri that decrease levels of signaling molecules which are associated with inflammation in microglial cells, a type of brain cell.

## HOW TO EFFICIENTLY NETWORK: FOR STUDENTS DESIRING A MORE COMPREHENSIVE HONORS EXPERIENCE, MEETING ROOM 7 (MR 7)

**Dillon Dejam - University of California, Irvine**

This fun, hands-on workshop is geared towards students looking to take their college experience to the next level by networking to find mentors, seek out work/research opportunities, and learn more from professionals. After attending this workshop, you will gain the tools necessary to make connections and build your network.

## BUILDING AN IDEAL COMMUNITY: MOTIVATIONS FOR THE CREATION AND STRUCTURE OF THE HONORS COLLEGE AT SOUTHERN OREGON UNIVERSITY, MEETING ROOM 8 (MR 8)

**Dr. Prakash Chenjeri and Dr. Ken Mulliken - Southern Oregon University**

“Building an Ideal Community: Motivations for the Creation and Structure of the Honors College at Southern Oregon University,” is an exploration and analysis of different versions of the ideal society, and explains the rationale for the creation and organizational structure of the Honors College at Southern Oregon University.

## HONORS STUDY ROOM, MEETING ROOM 9 (MR 9)

**Fay Kimball, Jennifer Marsh, Cassandra Roland, and Samantha West - Dixie State University**

There is a need for a study room designated for fifty honors students. The plans for the room will come from meetings with the faculty and students. Study rooms are a way for students to gather as a community of like-minded individuals and can also act as a classroom.



## SESSION 3 (cont.): 11:10AM-12:00PM

### **UNBOUND: OPEN MEDIA, CLOSED FORMAT, MEETING ROOM 10 (MR 10)**

**Dr. Amaris Ketcham and student presenters: Michael Andrews, Caitlin Carcerano, and Kimberly Mitchell - University of New Mexico**

Cartoons, music, cooking, websites—what are some of the philosophical, ethical, and legal questions that arise when you submit these kinds of “open media” works for publication in a print magazine? Come discuss some of these hairy issues with three seasoned student editors.

### **FIRST-YEAR MENTORING: MODELS FROM NEVADA, BALLROOM B**

**Dr. Daniel Villanueva with student presenters: Larissa Gloutak and Rachel Lucas - University of Nevada, Reno**

**Dr. Tiffany Schmier with student presenters Anna Gingrich and Sergio Trejo - University of Nevada, Las Vegas**

This panel introduces Honors mentoring programs at the University of Nevada, Las Vegas, and the University of Nevada, Reno. Honors students from both universities explain the theory behind their respective mentoring models and how the different models work in practice to assist in recruitment, retention, faculty-student engagement, and advising goals.

## LUNCH & KEYNOTE ADDRESS, 12:10PM-2:00PM RAINCROSS BALLROOM

*Lunch will be provided for all registered conference attendees. Please be sure to show your badge at the door for entry. Riverside City College Combo I will be providing some light jazz music during your meal. Dr. Kelechi A. Kalu, Vice Provost of International Affairs and Professor of Political Science at University of California, Riverside will be providing the Keynote Address.*

### PERFORMER: RIVERSIDE CITY COLLEGE COMBO I



Riverside City College Combo I is comprised of students that are also members of the RCC Jazz Ensemble. These are full-time students that keep a busy schedule of performances each semester. In past years RCC jazz students have traveled to the UNC Greeley, Reno, and the University of Texas Jazz Festivals, and have also performed in Japan and Hawaii. The ensemble is pleased to be able to return to Hawaii this spring and perform in the International Music Festival. Guest artists on campus in recent years have included: Wayner Bergeron, Carl Saunders, Don Shelton, James Moody, Bob McChesney, Mike Stern, Poncho Sanchez, Gary Foster, Alex Iles, Larry Koonse, Jeff Hellmer, Brandon Fields, The Airmen of Note, Rob Lockhart, Lori Andrews Quartet, Bill Reichenbach, Don Clarke, Lanny Morgan, Steve Hawk, Kye Palmer, Kim Richmond, Bart Samolis, Steve Tavaglione and Rick Margitza. The jazz program also commissions a new piece for Jazz Ensemble each spring. Recent commissions have come from noted jazz writers Bob Curnow, Dr. Jack Cooper, H. David Caffey, Matt Harris, Tom Hynes, Dr. James Miley, Dr. Chuck Tumlinson, Glenn Morrisette, Steven Schmidt and Sandy Megas. This year the ensemble has commissioned a new piece from Jeff Jarvis to commemorate the 100th birthday of the college and the move to the Centennial Plaza facility, the Coil School for the Arts.



# SESSION 4: 2:10PM - 3:00PM

## **GENDER ROLES IN THE ARTS, MEETING ROOM 1 (MR1)**

**Natalie Kowell - Chapman University**

### ***“Just Hum A Merry Tune”***

This oral presentation takes a closer look at Disney’s animated feature Snow White and the Seven Dwarfs and its messages regarding roles of women. More specifically, the paper observes how the music in the movie affects the perception of classic female stereotypes and how the music helps perpetuate these stereotypes.

**Lindsay Lake - Metropolitan State University of Denver**

### ***Unlearning Submission: Margaret Atwood’s Revisionary Poems***

This presentation examines gender roles, societal expectations of men and women, and the importance of mythology in contemporary culture by exploring Margaret Atwood’s remythologized poems (“Siren Song” and “Circe/Mud Poems”) which tell their mythological stories through previously unheard female voices.

## **CREATIVE WRITING PROCESS, MEETING ROOM 2 (MR2)**

**Logan Jones - Southern Utah University**

### ***The Maskin Project***

I wrote a multimedia, science-fiction novella about brain-computer interfaces that includes a soundtrack and several real-world scientific research citations. Overall, I want to share how I wrote it, the original elements I added, and some important things that I realized along the way.

**Kelsey Keener - Southern Utah University**

### ***Writing About My Riding***

Writing about my riding helped me make huge steps toward being a better writer and rider, and it had a lasting impact on me. It helped me remember how important writing is to me and how helpful evaluating myself can be in my education and achieving goals outside of academia.

**Michelle Reid - Southern Utah University**

### ***New Worlds***

I have always enjoyed writing and telling stories. I decided to edit my first novel and sent my manuscript to publishing agents; I wrote a good chunk of my next novel. I kept a blog of short stories and tracked my progress. It is exciting to see one’s story develop.





# SESSION 4 (cont.): 2:10PM-3:00PM

## ETHICS & POLITICS, MEETING ROOM 3 (MR3)

**Francisco Aviles - Fullerton College**

### ***From Fruits to Prison: The Criminalization of Latin American Immigrants in the Age of Mass Incarceration***

Through the lens of critical linguistics, the metaphors that have been created for crime and immigration will be analyzed in order to define what caused the current criminalization of immigrants. Through this analysis and self reflection on community organizing on immigration, implications for liberation are offered.

**Bryan Dean - MiraCosta College**

### ***A Dangerous Departure: The Loss of American Radicalism***

Enlightenment thinkers set in motion a radical tradition that encompassed American liberties. This radical behavior has recently departed from American politics, presenting a dangerous future for its citizens. Through a dialectical lens my research demonstrates why American radicalism is essential to preserve liberty.

**Regan Smith - Irvine Valley College**

### ***A Future without a Past?: The Loss of American Archaeological Collections***

Deficient federal regulations on archaeological collections management are jeopardizing the work and purpose of archaeology: artifacts and critical information pertaining them are being lost due to degradation. However, federal standards may be overhauled by utilizing Switzerland's curation practices as a model.

## ECONOMICS & POLITICS, MEETING ROOM 4 (MR4)

**Ashish Hingle - California State Polytechnic University, Pomona**

### ***The Evolution of News and Media Websites***

In this exploratory study, we examined 9 highly rated news and media websites in 4 categories and collected data on the evolution of design trends.

**Aveilana Saldaña - Southern Oregon University**

### ***Trouble in Paradise***

A look into the corporation-controlled politics of Hawai'i and the impact that businesses have on the agricultural welfare of the state. Also, what new laws mean regarding Hawai'i as an endemic hot spot.

**Timothy Smith - California State University, Fullerton**

### ***Understanding the Development of Welfare States: Political and Economic Transition Between the World War***

What indicators track the development of welfare states in the early twentieth century? This paper uses typologies to track the development of social programs in Anglophone democracies. Five trends are identified following a periodization beginning with experimentation, followed by consolidation and a golden age after World War II.





# SESSION 4 (cont.): 2:10PM - 3:00PM

## ISSUES IN HIGHER EDUCATION, MEETING ROOM 5 (MR5)

**Heather Buchanan - Southern Oregon University**

### ***Mental Health and Student Attrition***

Mental health is an issue that is receiving increased attention in higher education. This presentation summarizes student research comparing the mental health, stress, and social support of returning and non-returning students during fall term. Results from this study could help universities create more effective retention and mental health programs.

**Desiree De Pace - University of California, Irvine**

### ***Experiences of UCI Student Parents***

This presentation details the results of a study which examined the impact of student-parent's perceptions of role strain, institutional support, and psychological wellbeing upon academic success. As enrollment of non-traditional students in post-secondary education grows, institutions must create supports systems which increase the likelihood of academic success for non-traditional students.

**Madeline Embisan - El Camino College**

### ***Breaking The Ice, Breaking Yourself***

Underage drinking is so widespread that it's considered almost essential in order to have the perfect and typical college experience. The consequences are endless, but alcohol plays a significant role in brain maturation, risky sexual behavior, binge drinking and addiction, human tragedies, and even the increased risk of poor grades.

## CELL & MOLECULAR BASIS OF DISEASE, MEETING ROOM 6 (MR 6)

**Dillon Dejam - University of California, Irvine**

### ***Structural & Biochemical Characterization of the Pterin Cofactor in Bacterial Nitric Oxide Synthase***

Nitric oxide produced from bacterial nitric oxide synthase (NOS) protects the pathogens *Staphylococcus aureus* and *Bacillus anthracis* from antibiotic induced oxidative stress. This project uses X-ray crystallography and biochemistry to study structural differences between bacterial and human NOS that must be exploited in order to develop safe and successful therapeutics.

**Olivia Jaqua - Central Arizona College**

### ***Coliform Testing in Arizona's Water Bodies***

The presence of fecal coliform bacteria in aquatic environments indicates that the water has been contaminated with the fecal material of humans or other animals. This can cause waterborne pathogenic diseases. Does the amount of coliform increase as you travel downstream in the Salt River?

**Cecilia Nguyen - University of California, Irvine**

### ***Generation of Microglia from Human Induced Pluripotent Stem Cells***

In this presentation, I discuss a microglial differentiation protocol from induced pluripotent stem cells and human embryonic stem cells. This could be a potential method for obtaining microglia in order to further study the role of the innate immune system in neurological diseases such as Alzheimer's Disease and Parkinson's Disease.

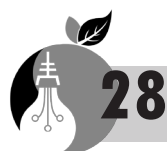



## SESSION 4 (cont.): 2:10PM-3:00PM

### **WHERE EVERYBODY KNOWS YOUR NAME: STUDENT LEADERS NURTURE A TIGHT-KNIT COMMUNITY, MEETING ROOM 7 (MR 7)**

**Daniel Coyle, Anna Gingrich, Louisa Heske, and Connor McCubbin - University of Nevada, Las Vegas**

In response to rapid growth of incoming classes, UNLV's Honors College turned to its student leaders to preserve and enhance our tight-knit community. This presentation discusses how the Honors Student Council has created a more inclusive and active community through launching unique events and programs in collaboration with Honors faculty/staff.

### **PROMOTING EMPATHY ON CAMPUS: REFOCUSING HOLIDAYS FROM PARTIES TO SERVICE, MEETING ROOM 8 (MR8)**

**Sarah Gaulke, Jebediah Rosen, Cassie Seigny - University of Montana**

The Honors Student Association (HSA) from the Davidson Honors College at the University of Montana refocuses traditional partying holidays from celebrations to service events by promoting empathy through hosting service-oriented events. HSA's main events are Valentines for Peace and Trick or Treat so Missoula Eats (TOTSME). Both events encourage students to consider the less fortunate rather than themselves on celebratory holidays and increase awareness about global and community issues. Valentines for Peace is a campus-wide series of events that shift the focus of love to helping people during the week of Valentines. TOTSME takes advantage of students' desire to participate in a childhood tradition while benefiting the local food bank through the collection of canned food instead of candy. These events have been popular at UM for providing fun for the holidays and service opportunities to all students in ways that positively affect their own community.

### **THEATRICAL STORYTELLING & MUSIC, MEETING ROOM 9 (MR 9)**

**Ashley Baker - William O. Douglas Honors College at Central Washington University**

***GG: A New Student Work***

GG is an original student production that uses theatre as a vehicle to understand, communicate, and promote change for women in video games and the gaming community. The art of theatrical storytelling is used to break down issues like body and costuming problems, harassment online, and misconceptions about gamer girls.

**Joel Ragona - William O. Douglas Honors College at Central Washington University**

***Creating and Performing a Composition for Tuba and Piano***

The presentation will include an original work for tuba and piano. There will be an explanation beforehand as to why composition is pertinent to the field of music education.

### **CANNABIS REFORM IN WESTERN CULTURE: A BUDDING TREND, MEETING ROOM 10 (MR 10)**

**Hannah Herbst, Samantha Morgan, Tyler Schad, and Mallory Scott - University of Colorado Boulder**

For 10,000 years, cannabis has been revered across indigenous societies for its medicinal and cultural values. This presentation will demystify cannabis and show how it's been misrepresented on global and local scales. Using Colorado as an example, we will also examine the effects of legal reform in present day.



# SESSION 5: 3:10PM - 4:00PM

## WHAT SELLS, MEETING ROOM 1 (MR1)

**Melissa Mokhtari - Irvine Valley College**

### ***Roadblocks to Automation: Methods to Instigate the Cultural Shift to Driverless Cars***

Various cultural influences have contributed to public apprehension of driverless car technology. By analyzing these cultural factors, as well as the probable impact of driverless cars on society, this research offers solutions via marketing and education to reverse the negative perceptions of this potentially revolutionary technology.

**Foster Peebles - William O. Douglas Honors College at Central Washington University**

### ***Equilibrium Pricing in the Cherry Markets***

This presentation will discuss cherry pricing in different markets during the course of a single season. The aim of my research is to find a specific price that will maximize sales and volume of cherries sold to all markets.

**Alexandra Vignau - MiraCosta College**

### ***Porte-Cochere Crusader: A Valet's Holy War on McDonaldization in a Grand Hotel***

An original case study by a valet of the never before considered irrational effects of McDonaldization in a luxury hotel. This unique lens reveals the iron cage between employees executing five star, five diamond service to guests who revealed via the data, a surprising preference for McDonaldization.

## DREAMers: UNDOCUMENTED STUDENTS IN HIGHER EDUCATION, MEETING ROOM 2 (MR2)

**Dr. Carol Johnson - Central Arizona College**

In the United States, 65,000 students complete high school annually labeled as both "graduate" and "undocumented." Approximately only 20% matriculate to higher education with legislation and Executive Orders regarding status severely affecting access. In addition to national data and trends, experiences of students in Arizona will be discussed.







# SESSION 5 (cont.): 3:10PM-4:00PM

## CINEMA THROUGH A DIFFERENT LENS, MEETING ROOM 3 (MR 3)

**Andrea Wall - Southern Utah University**

### ***Cinematic Ceramics***

In this presentation, the ties between cinema and ceramics will be discussed. The focus of the presentation will be three Alfred Hitchcock films that were seen from a new perspective through the process of creating ceramic tiles, and how this process will be developed further to form an honors thesis.

**Miriam Krainacker - University of Montana**

### ***Ruskis of Hollywood: Stereotypes and Cliches of Russians in American Cinema***

This oral presentation will analyze the depiction of Russian characters in American media, and will attempt to explain Russians are always the villains. By comparing film eras with American-Russian relations, I'll look for relations between cultural and political mindsets. A small segment will discuss the portrayal of Russians in television.

**Devin Marcus - Chapman University**

### ***"Her Beauty and Her Terror": The Use of Geography in Australian Horror***

By examining the use of Geography in Australian Horror Media, I established a connection both to Australian Aboriginal History and the practice of Tourism in Australia. The examination of the specific cultural forces in these works shows a bias against both Aboriginal History and Tourism in Australia.

## ORGANISMAL BIOLOGY, MEETING ROOM 4 (MR 4)

**Vanessa Reynolds - MiraCosta College**

### ***Manure Lagoons: Environmental Disasters and Contributors to Climate Change***

Concentrated animal feeding operations produce large amounts of organic waste, which is stored in manure lagoons. These lagoons have many negative environmental effects contributing to water and air pollution. Due to the high production of ammonia and methane in manure, the lagoons are also a large contributor to climate change.

**Tamara Russell - Mt. San Jacinto College**

### ***Western Burrowing Owl Population at Menifee Valley Campus, Mt. San Jacinto College***

The Western Burrowing Owl, *Athene cunicularia hypugaea*, population at the Menifee campus of Mt. San Jacinto College, was studied and found to be a vital population in need of protection. A conservation plan was established to protect burrows and contribute to the college as a research site for future students.

**Jennifer Shedden - University of California, Riverside**

### ***Escape Behavior and Flight Initiation Distance of the Granite Spiny Lizard, *Sceloporus orcutti****

Rock-dwelling lizards face unique challenges in locomotion and energy expenditure. While escaping a threat, a lizard must balance the cost of staying—the chance of being captured—with the energetic costs of flight. This experiment examined how the escape behavior of *Sceloporus orcutti* reflected its current habitat and environmental conditions.





# SESSION 5 (cont.): 3:10PM-4:00PM

## **ENGINEERING MODELS, MEETING ROOM 5 (MR5)**

**Anthony Klaib - California State Polytechnic University, Pomona**

### ***Aerodynamic Effects of Dimples on the Fuselage of an Aircraft***

Due to the large surface area of the fuselage, it contributes considerably to the overall aircraft drag. Using two model aircraft fuselages, one with and one without dimples, a CFD analysis and wind tunnel test will be conducted to determine if the dimples will reduce the overall skin friction drag.

**Alexander Koltz - Central Arizona College**

### ***Harvesting the Web***

Presentation on the techniques for the practical gathering of large quantities of data over the internet for analysis.

**Madelyne Weber - William O. Douglas Honors College at Central Washington University**

### ***Ellensburg Weather: A Time-Series Forecasting Model***

This presentation will showcase the forecasting model developed to find temperature predictions for Ellensburg, Washington. Through time-series analysis, historical temperatures are decomposed to unveil the seasonal variations and underlying patterns. The constructed models gives forecasts for high and low temperatures with easy to interpret measures of accuracy.

## **EDUCATIONAL TOOLS FOR YOUTH, MEETING ROOM 6 (MR6)**

**Francesca Curtolo - Sierra Nevada College**

### ***Children App for Healthy Diet***

The presentation proposed starts with the analysis of the issue of children's obesity. The concept of "The Nudge" represents my solution to it, and will take the form of a children's App. Through nudges and incentives, the App will overturn the role of unhealthy-food advertising, leading to healthier eating-behaviors.

**Brittany Dunn - University of Nevada, Reno**

### ***The Formative Evaluation of an Educational Tool to Help Curb Children's Intake of Sugary Drinks***

While health risks associated with increased consumption of sugar-sweetened beverages by children is identified, recognizing effective strategies to reduce intake is a functioning area of research. An investigation, via interviews, will be completed on preferences of eligible health care professionals in Washoe County regarding an educational tool on sugary drinks.

**Elizabeth Marshall - Scottsdale Community College**

### ***Reducing Recidivism: The Role of Education and Literacy in Prison***

A New Frontier, a documentary by student filmmaker Lizz Marshall, explores the contribution education makes within the prison system. The presentation will show the film trailer and discuss the impact of reducing recidivism by coupling prison literacy programs with post-release services. Ms. Marshall is the film's cinematographer, director, and editor.

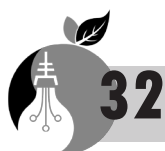



## SESSION 5 (cont.): 3:10PM-4:00PM

### **CULTIVATING LEADERSHIP SKILLS WITH “TAKE THE LEAD PROJECTS,” MEETING ROOM 7 (MR 7)**

**Ben Barnes, Kirsten Hawk, Christina Richardson, and Hannah Theophil - Southern Oregon University**

How do you enhance leadership skills for Honors students outside the classroom, while simultaneously sparking their creativity, prompting their community engagement, and reinforcing their focus on the university mission? Four Honors College students from Southern Oregon University would like share their experiences in creating their “Take the Lead Projects.”

### **(MIS)REPRESENT: THE PROBLEM OF DISNEY, MEETING ROOM 8 (MR 8)**

**Katherine Bay, Brittney Brott, Alyssa Carroll, and Miranda Ramirez - University of La Verne**

This presentation examines cultural and gender representations in several Disney films. Our analysis assesses the erasure of the historical implications of colonialism in Pocahontas and also demonstrates how characteristics traditionally associated with masculinity are represented positively in male heroes, but are shown as negative when seen in female villains.

### **DIVERSIFYING & DEMYSTIFYING HONORS COLLEGES: CREATING A SENSE OF BELONGING FOR DIVERSE STUDENTS, MEETING ROOM 9 (MR 9)**

**Anthony Muradas, Erica Rojas, and Jessica C. Valdes - University of Utah, Honors College**

This presentation will discuss the University of Utah Diversity Scholars-Honors College Partnership and the role this type of bridge programs play in creating access for diverse students, demystifying stereotypes about Honors programs, and creating a sense of belonging among these students.

### **ENTANGLED OPPRESSION: DIVERSIFYING OUR UNDERSTANDING OF OPPRESSION ACROSS SPECIES, MEETING ROOM 10 (MR 10)**

**Camille Moore and Anisah Spahn - University of Colorado, Boulder**

Modern research in sociology and ethics now considers the relationship between humans and animals as one of the interlocking forms of oppression. Human abuse of animals can be damaging to both parties; the physical and psychological harm seen in slaughterhouse workers demonstrates how animal maltreatment also negatively influences humans.

### **USING A COMMUNITY PEER MENTORING MODEL IN A GENERAL EDUCATION HONORS PROGRAM, BALLROOM B**

**Dr. Beth Wightman and presenters: Shantay Shabhaz, Alexander Nava, and Inderdeep Kaur - California State University, Northridge**

Our presentation will discuss how a community peer mentoring model works with first-year students at our large, public university, many of whom are first-generation college students and come from a wide variety of ethnic backgrounds. It will also examine how the diversity of the peer mentors themselves contributes to the program's effectiveness.



# MONTE CARLO CASINO SOCIAL

## 4:10PM-6:00PM

### RAINCROSS BALLROOM

*Students, staff, and faculty are all welcome! Please be sure to show your badge for entry. Play games, take photos, and enter a raffle to win prizes! Attendees will receive a commemorative WRHC 2016 poker chip for joining in on the fun!*



## 6:00PM - DINNER/EVENING ON YOUR OWN

*Take some time to visit Downtown Riverside and enjoy some delicious local eats and historic sites. Check out the Dining and Historic Sites maps provided to you at registration for a full list of dining locations and sites to see in Downtown Riverside.*

# Sunday April 10

## DETAILED SCHEDULE

### MT. RUBIDOUX HIKE 6:15AM - 8:00AM



Conference attendees interested in the hike to Mt. Rubidoux should meet at the Marriott lobby (3400 Market Street, Riverside, CA 92501) at 6:00am on Sunday April 10, 2016.

If there is rain the morning of the hike, the hike will be cancelled.

We will be leaving at 6:15am to start the walk to Mt. Rubidoux. We anticipate returning by around 8:00am.

#### **TRAIL INFO:**

The walk will be about 4.5 miles roundtrip (this includes the walk from the hotel to the base of Mt. Rubidoux and back). Although the walk itself will be on relatively flat and even terrain, there will be a slight incline. There are no bathrooms at Mt. Rubidoux or stops to use the restroom along the way to Mt. Rubidoux, so please be sure to use the restroom before the hike.

#### **WHAT TO BRING:**

- 1.) Please wear comfortable tennis/athletic shoes and appropriate workout clothes
- 2.) Light snacks if you get hungry
- 3.) Sunblock lotion/sunglasses
- 4.) Camera/smartphone to capture the spectacular views at the top of the mountain
- 5.) Bottle of water

#### **QUESTIONS?**

If you have any questions about the hike, please email UCR Honors Faculty Director Dr. Richard Cardullo at [richard.cardullo@ucr.edu](mailto:richard.cardullo@ucr.edu).

Please be sure to include in your e-mail subject line, "WRHC Hiker."



# BREAKFAST 8:00AM-9:00AM EXHIBIT HALL C

*As you enjoy your breakfast, Aventur will provide musical entertainment.*

## PERFORMER: AVENTUR

Aventur features two UCR undergraduate honors students who have performed at countless other UCR events and have made it their mission to spread music to all areas of the Riverside County. Taha Al Hassan plays the violin and Jericha Viduya provides the vocals, both accompanied by an Ableton sound board which can emulate the sound of any instrument. Their music encompasses all genres and their styles include covers, remixes, and original pieces. They hope to continue expanding their talent and composing their own music until this fall, when Taha will be attending the UCLA School of Dentistry and Jericha will be attending the UCR School of Medicine.



# WESTERN REGIONAL HONORS COUNCIL BUSINESS MEETING 9:10AM - 10:00AM BALLROOM (1st floor)

## INFORMATION FAIR 9:10AM - 12:00PM EXHIBIT HALL D

*The following sponsors and exhibitors will be available to provide you with more information about their organizations/institutions.*

**GOLD SPONSOR: FULBRIGHT**

**BRONZE SPONSOR: NATIONAL COLLEGIATE HONORS COUNCIL**

**EXHIBITORS:**

AUDEAMUS JOURNAL

CALIFORNIA WESTERN SCHOOL OF LAW

KECK GRADUATE SCHOOL

UNIVERSITY OF CALIFORNIA, RIVERSIDE :GRADUATE DIVISION (ACADEMIC PREPARATION & OUTREACH)

PEACE CORPS

PEPPERDINE GRADUATE SCHOOL OF EDUCATION & PSYCHOLOGY

TEACH FOR AMERICA

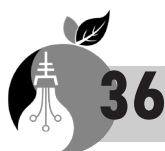



# STUDENT POSTER SESSION

## 9:10AM - 11:00AM

### EXHIBIT HALL D

*Poster Presentations are listed in alphabetical order by last name. If more than 2 people are presenting a poster, the last name that is closer to the beginning of the alphabet is listed first.*

1. Alexander, Ashley - University of Montana

#### **Better than Before and Better Together: Delineate Fitness Effect of E. Coli Evolved Strains Under Carbon Resources Limiting Boundary Conditions**

Quantifying relative fitness in experimentally evolved communities reveals that the sum may be greater than its parts, providing a clue as to how biocomplexity arises, even in simple systems governed by Darwinian principles.

2. Bledsoe, Kellsey and Pellegrini, Mason - University of Washington Tacoma

#### **Environmental Activism Strategies and the Palm Oil Crisis**

This presentation is on the communication strategies employed by environmental groups. The research in this project is split into two areas: communication with indigenous people and communication with the first-world public. First, general best practices are established, then they are used to analyze our case study: the palm oil crisis.

3. Bolts, Naomi and Richie, Micha - Metropolitan State University of Denver

#### **Diversifying Collegiate Honors Program: Engaging and Encouraging Non-Traditional Students of Color to Excel**

The following poster will look at the causes of under representation and potential solutions to this issue. The proposed solutions in this poster presentation offers a blueprint for future outreach initiatives that can serve to encourage and retain non-traditional students of color at Metropolitan State University of Denver's Honors Program.

4. Briones, Michael - University of Nevada, Las Vegas

#### **Identification of a Germination Receptor of Clostridium Difficile Utilizing Natural Mutagenesis**

Clostridium difficile is a bacterium found in the human gut and is the leading cause of hospital-acquired diarrhea worldwide. C. difficile spores germinate into harmful toxin-producing cells. This study aims to identify a novel C. difficile germination receptor. The identification of such receptor may further drug development against the pathogen.

5. Cano, Alejandra - Central Arizona College

#### **Asperger's: The Dichotomy of Interpretation, Treatment, and Diagnosis Between Mexico and the United States**

In the U.S, there is one child out on 88 diagnosed under the autism spectrum. In Mexico, there is one child out of 250 with the same diagnosis. Why the epidemic difference, when all that separates these two countries is a border?

6. Da Silva, Theresa - MiraCosta College

#### **Hydraulic Fracturing**

As demands for energy have increased, scientists have begun seeking out alternative ways to harness natural resources, one method being hydraulic fracturing or fracking. New research regarding nanoparticle tracers has shown that by implementing tracers into fracking fluids, oil companies can be held responsible for possible pollution they cause.

7. De Pace, Desiree - University of California, Irvine

#### **Children's Suggestibility and Response to Novel Interviewing Techniques**

This poster summarizes the results of a study conducted in which children were exposed to a novel experience and subsequently interviewed in order to gauge how various putative interviewing techniques and individual characteristics influenced their suggestibility.





# STUDENT POSTER SESSION

## 9:10AM - 11:00AM

### EXHIBIT HALL D

*Poster Presentations are listed in alphabetical order by last name. If more than 2 people are presenting a poster, the last name that is closer to the beginning of the alphabet is listed first.*

8. Estephan, Renee - California State Polytechnic University, Pomona

#### **“Spidey” Sequences: Finding Transposable Elements in the Genome Sequence of the Common House Spider, *Parasteatoda tepidariorum***

The genome of the common house spider, *Parasteatoda tepidariorum*, has recently become available. The goal of this project is to search this genome for transposable elements. Transposable elements are sequences of DNA that have the potential to facilitate their own movement from one genome location to another.

9. Flora, Rebecca - Southern Oregon University

#### **Crave the Third Wave: How the Coffee Industry is Changing**

Coffee is one of the top traded products in the world. Third-wave coffee is changing the way we buy and drink it. This presentation looks at how we are shifting our focus to higher quality and higher prices and what that means for the industry.

10. Hartman, Taylor - Northern Arizona University

#### **Through the Eyes of an Artist**

Bruce Aiken is the artist-in-residence for NAU's Honors Program. Working with students, he shares his love of painting and of the landscape of the Colorado Plateau. Two Honors students who have participated in his programs will show their work and discuss the experience of learning from the renowned artist.

11. Harvey, Valencia and Knife, April - Estrella Mountain Community College

#### **What Do You Know? Perceptions of Autism Among Estrella Mountain Community College Students**

This research investigates the knowledge and perceptions of Autism Spectrum Disorder among Estrella Mountain Community College students. The survey was designed to assess students' awareness of the causes, symptoms, diagnoses, prognosis and treatments related to Autism Spectrum Disorder. These results show the need for continued education on campus.

12. Holcombe, Cassandra - Central Arizona College

#### **Varying Methods to Control Pet Population**

My presentation is about the Honors Colloquium project I completed at Central Arizona College. This project was done in a year's time. The research covers surveys, interviews, and observations completed to look at varying methods to control the pet population and effects of overpopulation in animal shelters.

13. Ibrahim, Bavly - El Camino College

#### **Epigenetic Modifications in Cancer**

Epigenetic modifications including DNA methylation, Histone modifications and regulation by noncoding RNAs can give rise to cancer cells. Treatments are made based on the modification.







# STUDENT POSTER SESSION

## 9:10AM - 11:00AM

### EXHIBIT HALL D

*Poster Presentations are listed in alphabetical order by last name. If more than 2 people are presenting a poster, the last name that is closer to the beginning of the alphabet is listed first.*

14. Kelly, Conor - MiraCosta College

#### **Lessons From Lesions**

There are historical parallels that link modern Islamophobia to the outbreak of Sinophobia during the California plague of the 19th century and Anti-Semitism during the Bubonic plague. In all three cases, particular segments of society blamed minority groups for outbreaks of real or perceived viral epidemics with terrible consequences.

15. Kenner, Sarah - Chapman University

#### **The European Crisis Through a Literary Lens**

Across Europe, Muslim immigrants and traditional open Western values are on a collision course. This project uses Harvard sociologist Homi Bhabha's ideas of hybridity to analyze the young Palestinian immigrant Yahya Hassan's debut poetry collection about the tensions of growing up in a Middle-eastern immigrant community in Denmark.

16. Lytle, Brianna - El Camino College

#### **Gene Editing in Embryos: A Utilitarian's Defense to Promote the Good of Humanity**

A new gene editing system, CRISPR, allows scientists in the United Kingdom to understand how a healthy embryo develops; however, the United States restricts this procedure from taking place. As people, we ought to allow this type of genetic editing in order to promote the good of humanity for the future.

17. Mackey, Lucas - Embry-Riddle Aeronautical University

#### **Comeback for the Combi**

The Combination (Combi) aircraft is a multimodal aircraft with passenger and cargo capacity. Currently, the variant is stuck between retirement and a major comeback in the airline industry. An analysis of the efficiencies of the Combi and a financial statement assessment will allow airlines to improve their networking strategies.

18. Mason, Benjamin - University of Montana

#### **Complement Resistance in Bartonella Species**

Although complement resistance has been demonstrated in bacteria of the genus Bartonella, the exact mechanism of this phenomenon is unknown. Results of this study will allow us to analyze complement resistance in Bartonella and increase our understanding of complement resistance in other pathogenic bacteria.

19. Medina Ulloa, Ayla - William O. Douglas Honors College at Central Washington University

#### **Safe Space for All: Investigating the Possibilities and Limitation of Safe Spaces in Schools**

In recent years, there has been an increased interest in experiences of LGBTQ students in the United States. Focus has shifted to them because this population is regularly marginalized. In this research, I analyze the research on safe space projects in other schools and record what strategies have been helpful.





# STUDENT POSTER SESSION

## 9:10AM - 11:00AM

### EXHIBIT HALL D

*Poster Presentations are listed in alphabetical order by last name. If more than 2 people are presenting a poster, the last name that is closer to the beginning of the alphabet is listed first.*

20. Minervini, Kaitlin and Sharpe, Kylie - Estrella Mountain Community College

#### **The Future of ASD: Educating Children with Autism**

This project discusses the negative stigma of children with autism, the signs and symptoms of ASD and how it is treated. This project will educate the public about why autistic children need to be properly educated, as well as prove how people with ASD can be productive members of society.

21. Moseley, Jamie - Chapman University

#### **The Costs of Cancer**

Discrepancies in health care and socioeconomic differences can greatly affect one's already harrowing battle with cancer. This poster aims to examine the relationships between race, location, and treatment opportunities limited by healthcare policies, and explore the continually rising costs of cancer treatments.

22. Moseley, Jamie - Chapman University

#### **The Responsibilities of a College Newspaper**

To what standards should a college newspaper be held? The Panther, the Chapman University student newspaper, has regularly been subject to scrutiny, and this poster takes a critical look at the ethical values involved in the choice of articles published, advertisements run, and accuracy of the newspaper as a whole.

23. Mukherjee, Sohini - Chapman University

#### **Next Stop, Squalor - Foreign Perspectives on India and the Exoticism of Poverty**

This poster examines foreign literature and perspectives on India and the ways in which Oriental perspectives of the sub-continent fuel voyeur and slum tourism.

24. Nguyen, Anthony - University of California, Riverside

#### **Analysis of Reproductive Mode (Placental and Nonplacental) on Genetic Variation Across Geographically Isolated Populations of *P. prolifica* and *P. infans***

My undergraduate thesis project is the analysis of placental and non-placental reproductive modes on evolution by phylogenetic analysis. The subject of analysis is *Poecilopsis prolifica* (placental) and *Poecilopsis infans* (nonplacental). My hypothesis is that placental species have a faster rate of evolution than non-placental species.

25. Payne, Devon - University of Nevada, Las Vegas

#### **Use of an Organic Extract to Stimulate Growth of *Thermoflexus hugenholtzii* and Discover a Defined Medium**

*Thermoflexus hugenholtzii*, a thermophilic representative of a novel class in the phylum *Chloroflexi*, can only be grown using complex media, preventing physiological studies. We used an organic extract to increase the yield of this bacterium three-fold. Exometabolomics may reveal the compounds necessary for creating a defined medium for physiological studies.

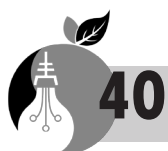



# STUDENT POSTER SESSION

## 9:10AM - 11:00AM

### EXHIBIT HALL D

*Poster Presentations are listed in alphabetical order by last name. If more than 2 people are presenting a poster, the last name that is closer to the beginning of the alphabet is listed first.*

26. Perez, Nicole - University of California, Riverside

#### **“Smart Drugs” and Students...What Students Really Think**

Research shows cognitive enhancement drugs (CEDs) have gained popularity among students and that personality/demographic factors predict views towards CEDs. We examined open-ended explanations for student views of CEDs to understand factors that predict CED acceptance. Results suggest students are concerned about legality of CED use and note potential health benefits.

27. Rhode, Kristen - University of Alaska, Fairbanks

#### **Hot Dogs with Relish: Brown Fat Thermogenesis in Alaska Sled Dogs**

Brown adipose tissue (BAT) generates heat in mammals. Alaska sled dogs live at temperatures below -40 C. We tested BAT thermogenesis using a thermal camera, and compared measurements at room and outdoor temperatures ranging from 0 to -30 C. Current results suggest thermogenesis and an increase with declining ambient temperature.

28. Samara, Omar - California State University, Bakersfield

#### **Development of Autonomous Unmanned Aerial Vehicle for Pesticide Application in Agriculture**

Pests are a serious problem in all of agriculture, and conventional methods of pesticide application raise health, environmental, and financial concerns. Autonomous unmanned aerial vehicles provide a system based solution which can be applied to address all those concerns in a meaningful manner.

29. Schwartz, Jonathan; Scirocco, Aaron - Estrella Mountain Community College

#### **Derive and Contour**

For this project we decided to take an equation for a mountain and generate it in a computer algebraic system called MAPLE. By taking the model in the program we applied it in real life and made a visual representation.

30. Stewart, Kindle - Paradise Valley Community College

#### **The Call for Cloning**

An experiment was conducted to prove that artificial cloning in labs is possible. The experimenter successfully produced twelve cauliflower clones despite having eighteen contaminated or stunted attempted clones. The idea of artificially cloning cells can be applied to many fields, but will prove to be a great benefit in medicine.

31. Tajalli, Linda - El Camino College

#### **Cancer and Death? The Effects of Genetically Modified Foods on the Liver**

Prolonged consumption of genetically modified foods, as opposed to organic foods, can increase the risk of developing liver diseases. Research on rodents has shown that rats fed genetically modified foods tended to develop significant changes within liver cells, such as hemorrhage and impaired protein expression.





# STUDENT POSTER SESSION

## 9:10AM - 11:00AM

### EXHIBIT HALL D

*Poster Presentations are listed in alphabetical order by last name. If more than 2 people are presenting a poster, the last name that is closer to the beginning of the alphabet is listed first.*

32. Tice, Jordan - University of Nevada, Reno

#### **The Role of Galectin-1 in Duchenne Muscular Dystrophy Disease Progression**

Duchenne Muscular Dystrophy (DMD) is a genetic disorder caused by mutations in the dystrophin gene. Patients who present with this life-threatening disease suffer from irreversible effects on the diaphragm resulting in premature death. This study will provide evidence that Galectin-1 plays a role in the mechanism and pathology of DMD.

33. Tran, Jason - University of California, Riverside

#### **Assessing the Knowledge, Attitudes, and Beliefs of HIV/AIDS Among Undergraduate and Medical Students**

In 2010, youths disproportionately compromised HIV/AIDS diagnoses. Several studies, focusing on young adult undergraduate and medical students across different colleges, have shown mixed results in levels of knowledge and attitude toward HIV/AIDS. Our study focuses on knowledge, attitudes, and beliefs among students or recent graduates of UC Riverside.

34. Yund, Seth - Chapman University

#### **Effects of Human Recreational Activity on The Tameness of Common Loons (*Gavia immer*) in Northern Wisconsin**

The Common Loon (*Gavia immer*) is an aquatic diving bird that displays many interesting behaviors. The development of a safe method of capture has made it possible to keep track of individual loons over time. With this information, we have analyzed which factors cause differences in tameness behavior between individuals.

# POSTER AWARDS & CLOSE OF CONFERENCE

## 11:10AM - 12:00PM

### EXHIBIT HALL C

# UCR & SOU CONFERENCE PLANNING

## TRANSITION MEETING

### 12:10PM - 1:00PM

### EXHIBIT HALL C





# MODERATOR INSTRUCTIONS

During the WRHC 2016 workshop sessions, moderators will provide oversight, ensure smooth flow of each session, and encourage participation and interaction between presenters and audience members.

Moderator duties include:

1. Welcoming all participants and officially convening the session they are overseeing;
2. Introducing each individual presentation and corresponding presenter(s), including university/college affiliation and any other relevant information;
3. Ensuring that time is appropriately allotted so each presentation has equal and adequate time within each 50 minute session (each session may have 1 - 7 speakers - please allot time accordingly);
4. Allowing time for comments and questions from the audience at the conclusion of each individual presentation;
5. Facilitating questions and comments from the audience, and allowing each presenter to contribute to the discussion;
6. Taking notes on presentations to initiate questions and discussion, if needed; and
7. Closing the session and informing participants about the upcoming agenda item, whether that be another session, a break, an activity, or a meal.

# ATTENDING INSTITUTIONS

Arizona Western College  
California State Polytechnic  
University, Pomona  
California State University,  
Bakersfield  
California State University, Fullerton  
California State University,  
Northridge  
California State University,  
Stanislaus  
Central Arizona College  
Central Washington University  
Chapman University  
Collge of the Siskiyou  
Dixie State University  
El Camino College  
Embry-Riddle Aeronautical  
University  
Estrella Mountain Community  
College  
Everett Community College  
Flathead Valley Community College  
Foothill College  
Fort Lewis College

Fullerton College  
GateWay Community College  
Idaho State University  
Irvine Valley College  
Lansing Community College  
Mesa Community College  
Metropolitan State University of  
Denver  
MiraCosta College  
Mt. San Jacinto College  
Northern Arizona University  
Orange Coast College  
Paradise Valley Community College  
Pima Community College  
Rio Salado College  
Riverside City College  
Scottsdale Community College  
Sierra Nevada College  
Southern Oregon University  
Southern Utah University  
Tacoma Community College  
University of Montana  
University of Alaska, Fairbanks  
University of California, Irvine

University of California,  
Riverside  
University of Colorado Boulder  
University of Idaho  
University of La Verne  
University of Montana  
University of Nevada, Las Vegas  
University of Nevada, Reno  
University of New Mexico  
University of San Francisco  
University of Utah  
University of Washington  
University of Washington Tacoma  
Washington State University  
Western State Colorado  
University  
Western Washington University

# ACKNOWLEDGMENTS

University Honors at UC Riverside would like to thank the following individuals and organizations for their assistance, feedback, and goodwill:

## **2016 WRHC Sponsors, Exhibitors, & Donors:**

Undergraduate Education, UC Riverside  
University Honors Howard H Hays Chair Endowment Fund, UC Riverside  
Fulbright  
National Collegiate Honors Council  
California Western School of Law  
Keck Graduate School  
Peace Corps  
Pepperdine Graduate School of Education & Psychology  
Teach for America  
Graduate Division (Academic Preparation & Outreach), UC Riverside  
University Study Abroad Consortium (USAC)

## **2016 WRHC Officers:**

President Daniel Villanueva, Ph.D., Assistant Director, Honors Program, University of Nevada, Reno  
Executive Secretary/Treasurer Anne Scott, Ph.D., Professor of English; Honors Instructor, President's Distinguished Teaching Fellow, Northern Arizona University

**Aventur** - Taha Al Hassan & Jericha Viduya  
Diane Del Buono, UC Riverside Chancellor's Associate

## **Office of the Mayor, Riverside:**

Mayor William "Rusty" Bailey  
Riverside City Hall: Grier Pavilion

## **Riverside Community College:**

Amy Cardullo - Director, Riverside Community College District Foundation & Alumni Affairs  
Riverside City College Combo I  
Riverside Community College Printing & Graphics Center

## **Riverside Convention Center**

## **SOU Honors WRHC Interns**

Lauren Aldana  
Riley Evetts  
Brianna Morgan  
Micaela Saling

## **UC Riverside Barbara and Art Culver Center of the Arts**

## **UC Riverside Honors Ambassadors & Student Volunteers**

## **UC Riverside Honors WRHC Interns**

Jessica Gonzalez-Lopez  
Yo Yo Hong  
Melanie Queponds  
Ricky St. Claire

## **UC Riverside Agriculture & Operations**





# WRHC 2016 SPONSORS

## PLATINUM SPONSOR:



\$10,000 Donation - [ue.ucr.edu](http://ue.ucr.edu)

## GOLD SPONSORS:



[honors.ucr.edu](http://honors.ucr.edu)



<http://us.fulbrightonline.org/>

## BRONZE SPONSOR:



NATIONAL COLLEGIATE  
HONORS COUNCIL

[nchc.org](http://nchc.org)



# UPCOMING WRHC CONFERENCES

**2017**

Southern Oregon University



[honorscollege.sou.edu](http://honorscollege.sou.edu)

[honorscollege@sou.edu](mailto:honorscollege@sou.edu)

(541) 552-6400

**2018**

Chapman University



**CHAPMAN  
UNIVERSITY**

[chapman.edu/academics/honors](http://chapman.edu/academics/honors)

[honors@chapman.edu](mailto:honors@chapman.edu)

(714) 744-7646





# WRHC CONSTITUTION

## ARTICLE 1: Name

This organization shall be known as the Western Regional Honors Council (WRHC).

## ARTICLE 2: Objective

The objective of this Council shall be promotion and advancement of honors and similar programs in western colleges and universities.

## ARTICLE 3: Membership

Membership in the Council shall be institutional membership. Institutional membership shall be open to institutions of higher learning as well as to foundations and government agencies interested in honors and similar programs. Each institutional member shall be entitled to one vote.

## ARTICLE 4: Voting Body

One representative of each institutional member shall be entitled to vote in all transactions of the Council.

## ARTICLE 5: Officers

Officers of the Council: Definitions and Duties

The officers of the Council shall be a President, a Vice President, and an Executive Secretary/Treasurer.

The President, or in his/her absence the Vice President, shall preside at all meetings of the organization, shall appoint committees, shall maintain communication with members of the Council, shall offer advice to the WRHC conference coordinator, and shall perform other duties as pertain to the office of the President.

The Vice President is defined to be the conference coordinator of the current annual WRHC conference. The Vice President shall assume the responsibilities of coordinating the annual WRHC conference by choosing a date and location for the conference in a timely fashion, disseminating the "Call for Papers," selecting the papers and presentations for inclusion in the conference, and performing all other duties applicable to this

position.

The Executive Secretary/Treasurer (EST) is defined to be the person in charge of keeping minutes of the meetings of the Council and performing such other duties incidental to the conduct of his/her office as may be required of her/him. In particular, s/he shall collect and manage all fees and dues owing to the organization and shall be the custodian of the Council's funds. S/he shall make an annual report to the organization as secretary and submit annually a complete and verified statement of the financial condition of the organization. S/he shall also serve as liaison with the headquarters of the National Collegiate Honors Council. The EST shall be responsible for regularly updating the WRHC website.

## Selection Process for Officers of the Council; Terms of Office

The Vice President assumes the position of President at the business meeting of the annual WRHC conference. The President shall hold office for one year or until his/her successor is installed.

The conference coordinator of the following annual WRHC conference shall assume the position of Vice President at the business meeting of the current annual WRHC meeting. He/she shall hold this title until the business meeting of the following annual WRHC conference, at which point he/she assumes the role of President. In the event of the President's death or incapacity during his/her term in office, the Vice President shall assume the duties of the President sooner than the business meeting of the following annual WRHC conference.

The Executive Secretary/Treasurer shall be elected at an annual meeting for a three-year renewable term. The headquarters of the WRHC shall reside at the home institution of the Executive Secretary/Treasurer.

Ordinarily, new officers shall be installed at an annual business meeting. If it is not possible to elect a new Executive Secretary/Treasurer at an annual business meeting and/or to have the Vice President assume the role of President, then such an election and/or installation shall take





place in a vote by mail.

The President shall hold office for one year or until his/her successor is installed. The President, or in her/his absence the Vice President, shall preside at all meetings of the organization, shall appoint committees, and shall perform such duties as pertain to the office of President.

The chair of the following annual WRHC conference will assume the position of vice-president and succeed automatically to the office of the president and shall hold office for one year or upon the death or incapacity of the President, whichever occurs first.

The Executive Secretary/Treasurer shall be elected at an annual meeting for an indefinite term. The headquarters of WRHC shall reside at the home institution of the Executive Secretary/Treasurer.

The Executive Secretary/Treasurer shall keep minutes of the meetings of the Council and perform such other duties incidental to the conduct of his/her office as may be required of her/him.

S/he shall collect and manage all fees and dues owing to the organization and shall be the custodian of the Council's funds. S/he shall make an annual report to the organization as secretary and submit annually a complete and verified statement of the financial condition of the organization.

S/he shall serve as liaison with the headquarters of the National Collegiate Honors Council.

Ordinarily, new officers shall be installed at an annual meeting.

#### **ARTICLE 6: Meetings**

The Council shall hold two annual meetings: one in conjunction with the annual meeting of the National Collegiate Honors Council and one in conjunction with the annual meeting of the Western Regional Honors Council at a time and place to be determined by the membership at an annual meeting.

#### **ARTICLE 7: Mail vote**

Between meetings, any question or item of business shall be submitted by the Executive Secretary/Treasurer to a vote of the Council membership by mail.

#### **ARTICLE 8: Amendments**

Any proposal to alter or amend this constitution shall be submitted in writing to the Executive Secretary/Treasurer for suitable wording which clearly expresses the intent of the proposal and which is consistent with the other sections of the Constitution. The Executive Secretary/Treasurer shall distribute a copy of the proposed alteration or amendment to each institutional member prior to the annual meeting. Such alterations and amendments shall, upon receiving at a regular annual meeting a two-thirds majority of those present and voting, become a part of the Constitution.

#### **BY-LAWS**

#### **ARTICLE 1: Dues and voting rights**

Section 1. The annual dues for institutional membership shall be fifty (50) dollars.

Section 2. Only those institutional members whose dues are paid by the time of the annual conference are entitled to a vote in the Business meeting of the Council.

Section 3. Any member in arrears for one year shall be dropped from the rolls.

#### **ARTICLE 2: Annual Conference**

Section 1. The conference coordinator (Vice President) will plan the budget such that the conference will not end in deficit.

Section 2. Fees for the spring annual conference will be approved by majority vote at the fall meeting.

Section 3. Conference surplus revenues shall be transferred to the WRHC account as soon as all revenues have been collected and the bookkeeping for the conference completed. The WRHC will consider helping host institutions with conference costs by giving them a certain sum of money, to be both negotiated between the WRHC council and the Vice President and designed to keep conference fees as low as possible.

Section 4. Refunds for members unable to attend the conference for a valid reason, will be considered by the officers after the conclusion of the conference depending on funds available less 1%.

Section 5. The host institution will reimburse itself for conference costs incurred including administration, copy and publication costs, and travel.





Section 6. Student conference fees will be lower than faculty and administrators fees.

Section 7. The conference chair will submit a written financial report, including a final conference budget, to the executive secretary/treasurer and next conference organizers no later than two months after the conference.

Section 8. WRHC will provide seed money to those institutions that need it for the initial costs associated with planning a WRHC conference. It is expected that the seed money will be recovered from conference fees and returned to WRHC.

Section 9. The host institution of the WRHC conference will pay for the Scribendi reception at the WRHC conference through conference funds. In addition, the Scribendi winners attending the WRHC conference will have their conference registration fees waived by the host institution, which will pay for these fees through conference funding. Those persons who have been published in Scribendi will be encouraged to attend the conference but will not have their conference fees or other expenses waived.

Section 10. The conference host institution may invite up to three student interns to assist at the current conference from the institution hosting the following WRHC conference. Registration fees for these student interns shall be waived. A stipend from WRHC funds shall be paid to student interns for documented travel and lodging expenses at an amount to be determined yearly by the WRHC Executive Board.

### **ARTICLE 3: Scribendi, WRHC forum**

Section 1. The WRHC will support Scribendi financially annually for publication which is done by students in the Honors Program at the University of New Mexico.

Section 2. The WRHC will provide awards to students who win the competitions in each category.

Section 3. The WRCH will provide judges for the Scribendi contests.

### **ARTICLE 4: Special initiatives**

Section 1. The WRHC will provide stipends for WRCH students participating in an NCHC Honors Semester.

Section 2. The WRHC will provide travel awards for regional students who are elected to an NCHC position.

### **ARTICLE 5: President's Council**

Section 1. A President's Council will consist of no more than 5 WRHC members. The members will include the current WRHC President, the current WRHC Vice President, the former WRHC President, the current WRHC Executive Secretary/Treasurer, and one member to be appointed at large.

Section 2. The President's Council will be formed after a discussion between the current WRHC President and the most recent former WRHC president. Potential President's Council members will then be contacted and invited to be part of this council.

Section 3. The duties of the President's Council will be to help find a suitable location for the next WRHC conference, to discuss suitable locations with potential hosts, to provide advice to WRHC Vice President (conference coordinator) about the logistics and costs of the conference, to meet at the annual WRHC and NCHC conferences, and to discuss and help resolve unfinished WRHC issues that have been or will be raised at the bi-annual WRHC business meetings.

### **ARTICLE 6: Amendments**

Any proposal to alter or amend these by-laws shall be submitted in writing to the executive secretary/treasurer who shall distribute a copy of the proposed alteration to institutional members prior to the annual meeting. Such alterations shall, upon receiving, at a regular annual meeting, a simple majority of those present and voting, become a part of the by-laws.















































